



## OWNERS INSTRUCTION MANUAL

132CM/52"

# Zeta

INSTALLATION  
OPERATION  
MAINTENANCE

### CAUTION

READ INSTRUCTIONS CAREFULLY FOR SAFE  
INSTALLATION AND FAN OPERATION. IF UNSURE CONSULT  
A QUALIFIED ELECTRICIAN

SUITABLE FOR 230V/50 CYCLE ELECTRICAL SUPPLY  
Enquiries on installing your fan please call our help line on

**01959-564440**

E-mail :  
[technical@fantasiaceilingfans.com](mailto:technical@fantasiaceilingfans.com)





## **Safety Precautions**

1. To ensure the success of the installation be sure to read the instructions and study the diagrams thoroughly before commencing.
2. All electrical work should only be undertaken after disconnection of the power by removing fuses or turning off the circuit breaker to ensure all pole isolation of the electrical supply. If you are in any doubt the services of a qualified electrician should be sought to ensure that all work is carried out in accordance with the I.E.E. Regulations, current good practice and other national and local electrical codes.
3. Make sure that your installation site will not allow the rotating fan blades to come into contact with any object and that there is a minimum clearance of 150mm (6") from the blade tip to the wall or ceiling. Please note that the bigger this clearance is the better the airflow from your fan will be. Ensure the blades are mounted at a minimum height of 2.3 meters (7'6") from the floor when the fan is installed.
4. The fixing point for the fan must be able to support a weight of ten times that of the net weight of the fan. Net weights can be found on the bottom of the unit's box. If you are mounting the fan to a ceiling junction box, the box and it's fixing must be able to support the moving weight of the fan and must not twist or work loose.
5. The fan must be earthed.
6. Do not connect the fan motor to a dimmer switch. This may give an unsatisfactory performance (motor hum) and cause damage to the motor.
7. It is not recommended that ceiling fans and gas appliances are operated in the same room at the same time.
8. The fan must be turned off and stopped completely before reversing the fan direction. This will prevent any damage to the motor of the unit or controller (if installed).
9. Do not insert anything into the fan blades while the fan is operating. This will damage the blades and upset the balance of the unit causing the unit to wobble.
10. After the fan is completely installed make sure that all connections are secure and tight to prevent any problems.
11. Because of the fan's natural movement, some connections may loosen. Check the support connections, brackets and blade attachments twice a year to make sure they are all secure. If they are loose tighten with a screwdriver. ( It is not necessary to take the fan down from the ceiling )

**Note :** The important safeguards and instructions given in this manual are not meant to cover all possible conditions and situations that may occur. It must be understood that common sense, caution and care are factors which cannot be built into any product. These factors must be supplied by the persons caring for and using the unit.

For installation advice, or in the unlikely event of damaged or missing parts, please ring our help no. or send a e-mail to us:

**HELPLINE : 01959 564440**  
**E-mail : [technical@fantasiaceilingfans.com](mailto:technical@fantasiaceilingfans.com)**

## Supplied Parts

- One fan with DC motor assembly
- One round plate fitted
- One set of wooden blade
- One screw-pack
- One installation booklet & optical clothes
- One Remote Control Set
- One light fitter and glass
- One 60W G9 bulb or One LED light kit

## Tools and Materials Required

- Philips screwdriver
- Blade screwdriver
- Small electrical screwdriver
- Electrical pliers
- Step ladder
- Wiring supplies as required by current electrical practice

Before starting the assembly and installation of your fan please ensure the safety precautions have been read and understood.

## Installation Difficulties, Missing or Damaged Parts

If you have any difficulty in installing your fan/light or if you are unfortunate enough to find that your fan has been dispatched with parts missing or damaged please contact our help-line on ( 01959 564440) or send a e-mail with following mail address. We will be very pleased to provide help or forward replacements parts to you immediately.

In any communication with us please quote model reference, colour of the unit and the part missing or damaged.

**HELPLINE**  
**01959 564440**

**E-mail : [technical@fantasiaceilingfans.com](mailto:technical@fantasiaceilingfans.com)**

## Parts list for fan with G9 light kit

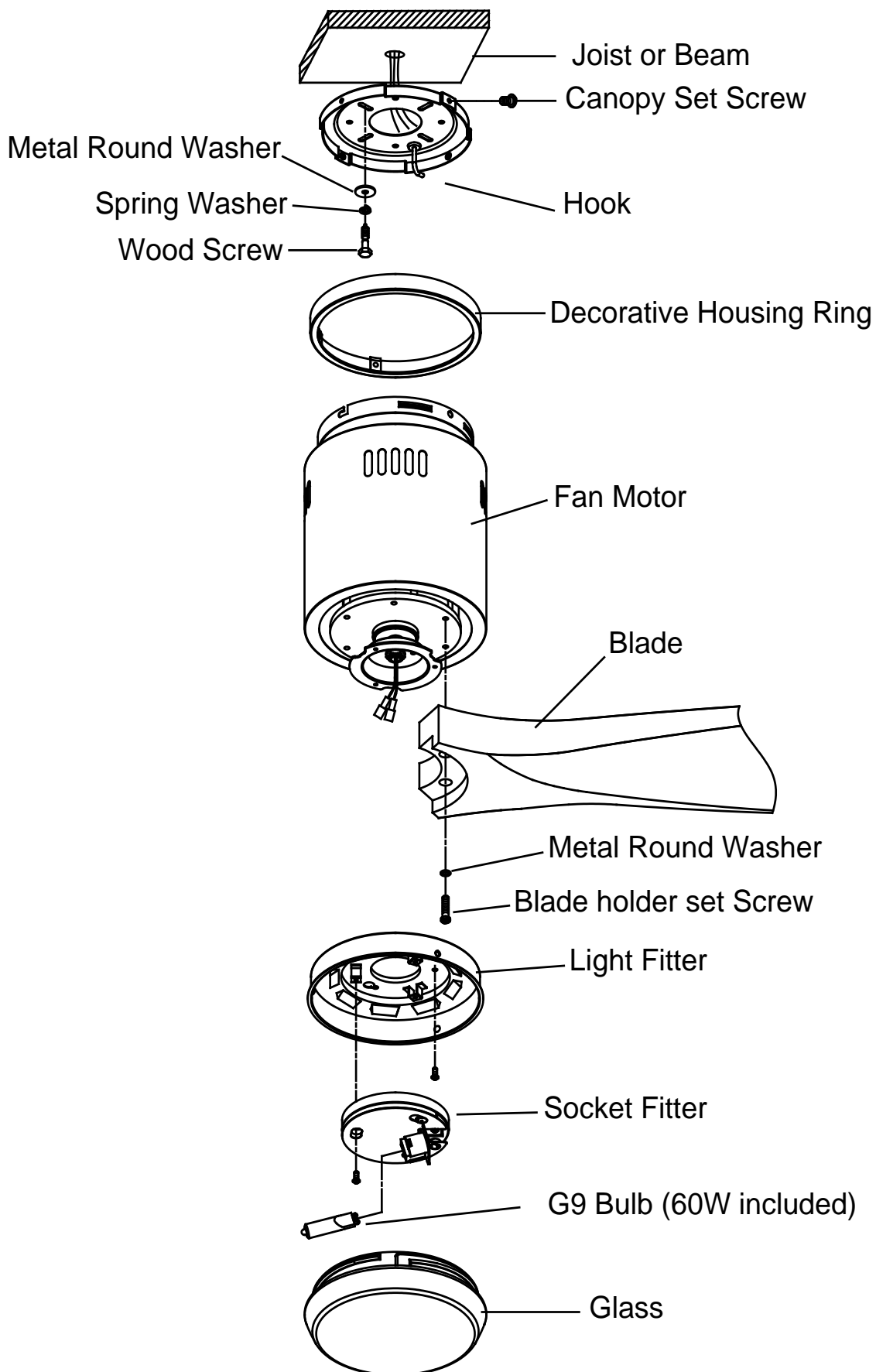

## Parts list for fan with LED light kit

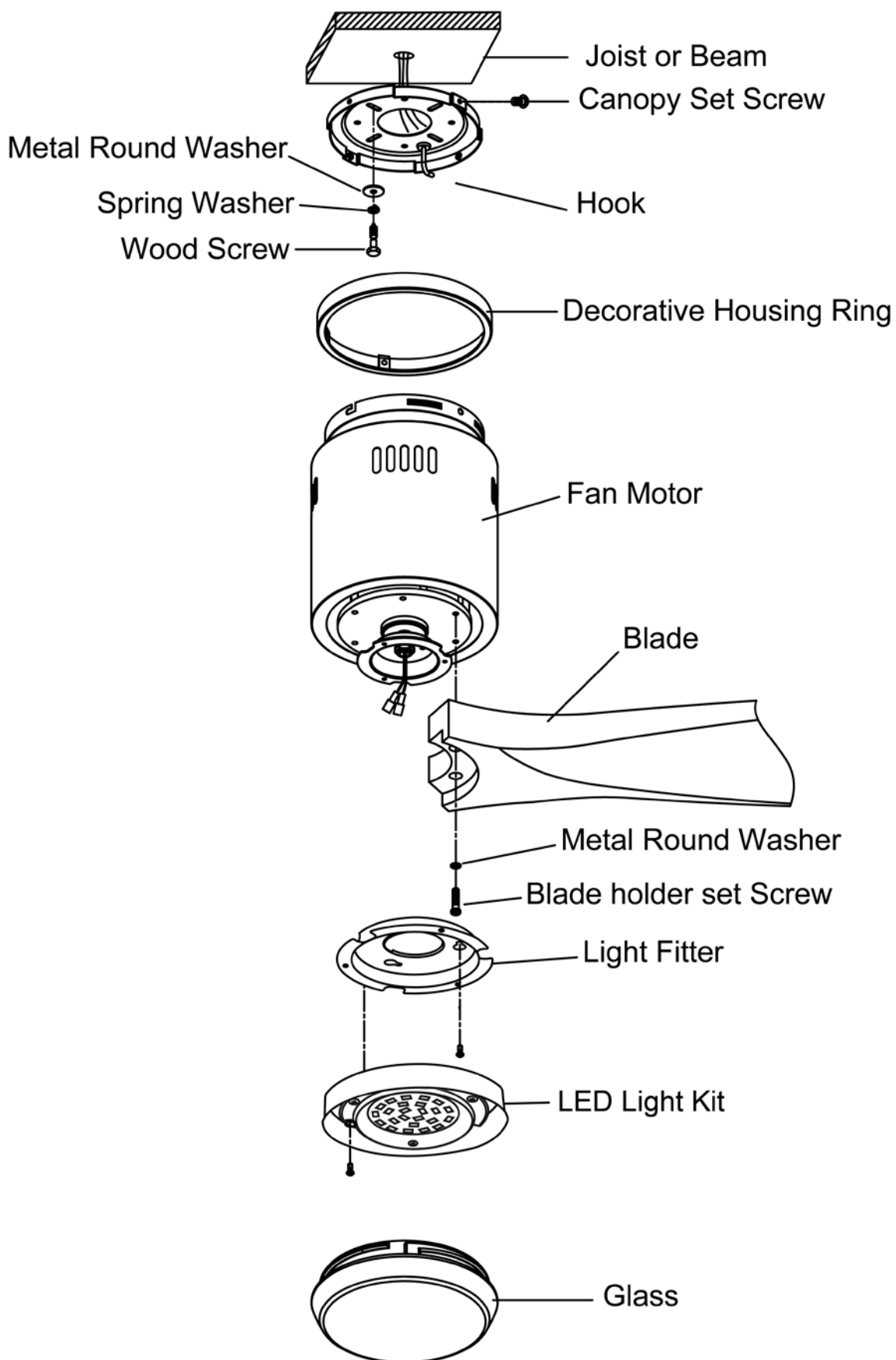

## Installing the fan

All electrical work should only be undertaken after disconnection of the power by removing fuses or turning off the circuit breaker to ensure all pole isolation of the electrical supply.

Your fan can only be installed flush mount style, as following picture.



The following steps will guide you to a successful installation:

1. Mounting plate installation
2. Fan motor housing installation to mounting plate
3. Wiring instructions
4. Attaching the blades to the fan
5. Attaching lighting plate and glass to the fan
6. Setup remote control

### 1. MOUNTING PLATE installation

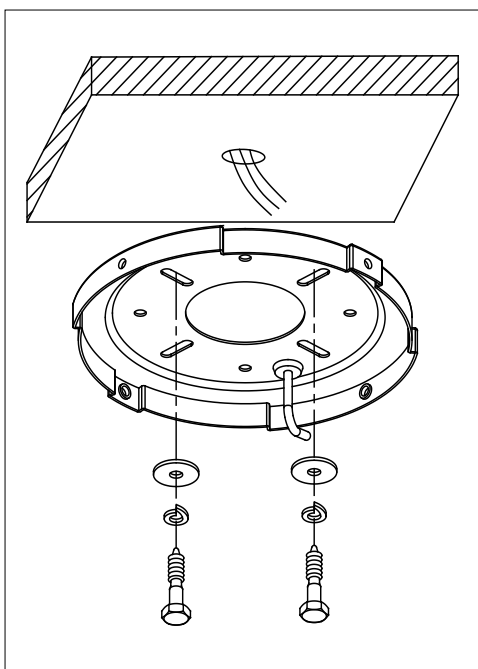

The mounting plate should be screwed on to a firm flat surface. The fixing location must be able to withstand ten times the static weight of the fan. If you have any doubts as to the ability of your intended fixing location to be able to withstand this loading, please contact our service help-line or another competent authority to advise you. In most situation two wood screws screwed into a wooden joist is more than adequate to support your ceiling fan.

The mounting plate should be screwed onto the joist with the two wood screws provided. The washers provided should go in the following sequence:

**Wood screw > Spring washer > Metal round washer > mounting plate > Ceiling.** Screw the mounting plate to the ceiling and make sure all connections are secure to prevent the fan from falling . Fixings must screw into a joist and not just the plasterboard.

## 2. Fan motor housing installation

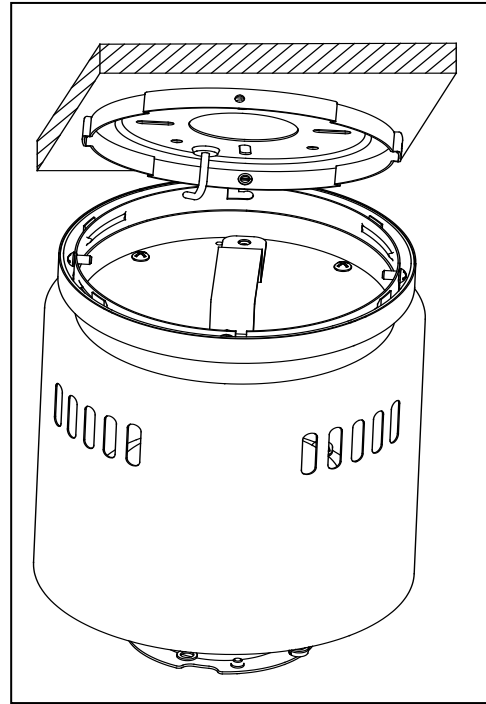
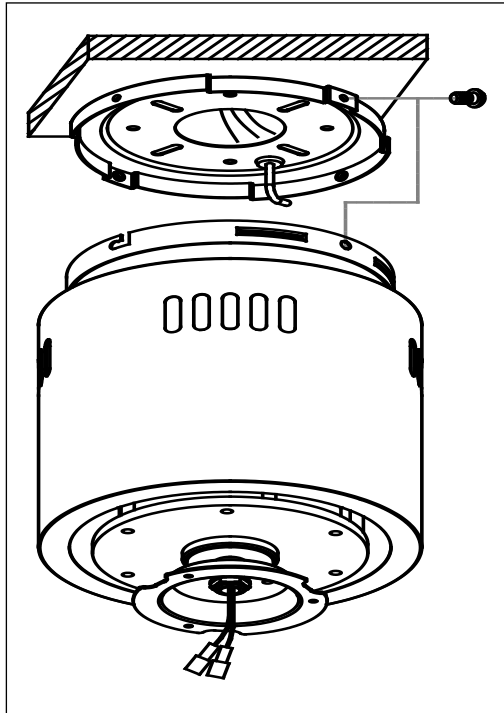

Push down the decorative housing ring, then hang the motor housing on to the “HOOK” that is on the mounting plate for wiring connection. Carefully use one of the holes, not the slots to hang the fan

## 3. Wiring instructions

**WIRING INSTRUCTIONS : Before doing wiring, ensure that you have all pole disconnection of the electricity supply.**

Your fan is supplied with a DC motor system and radio frequency remote control unit, and the fan does not have a pull switch for speed control, the fan can only be controlled by remote control. The DC motor system and remote control unit had been pre-assembly into the fan, you just need to connect A.C. power to fan motor. Please see following step drawing for wiring connection.

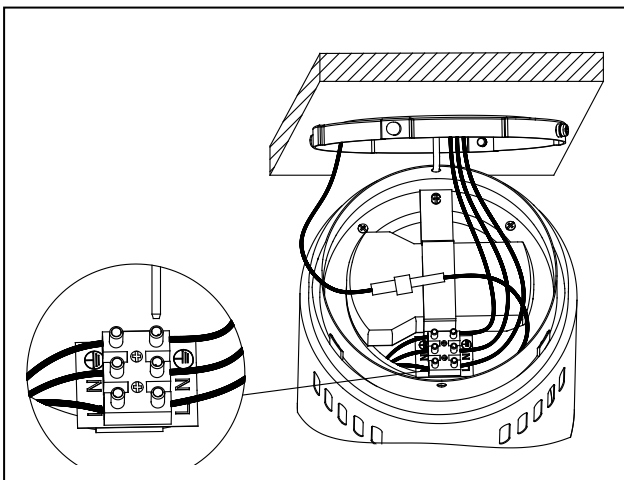

After hanging on the fan motor to hook on the mounting plate.

Connect the A.C. power supply wire that come from the ceiling to the Brown and blue wire of terminal block which is mark with label “L” & “N”. In most cases, BROWN/RED wire is LIVE is connected to “L” BROWN wire, BLUE / BLACK wire is NEUTRAL is connected to “N” BLUE wire. Connect GREEN/YELLOW wire to EARTH.



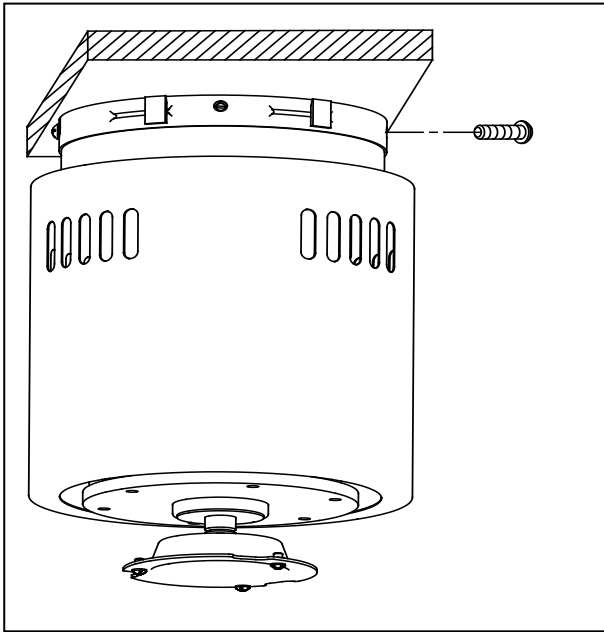

Take the weight of the fan and offer the canopy up to the mounting plate. Two keyed slots in the canopy will align with the two screws that have been left in the mounting plate.

Lift the fan and twist the canopy. This will now take the weight of the fan. Promptly insert the two remaining screws in the mounting plate. Tighten all four screws to ensure a good safe fixing.

Push the decorative housing ring back to Cover screws hole on the edge of mounting plate.

**IMPORTANT : THIS APPLIANCE MUST BE EARTHED.**

#### 4. Attaching the Blades to the Fan

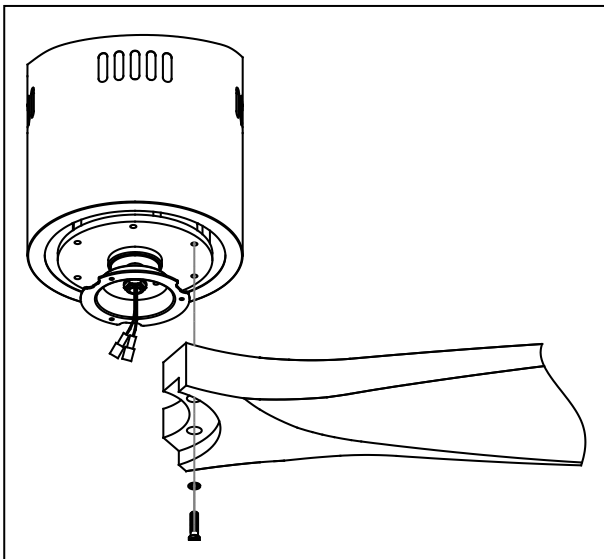

Carefully unwrap the blade. Align the blade with the holes on the motor. Use the screws and metal washers provided to connect them.

The metal round washer should go on top the blade between the head of the screw and the surface of the blade. Ensure the screws are tightened up firmly.

Repeat this process for all blades.

## 5. Attaching the G9 light fitter and glass to the Fan

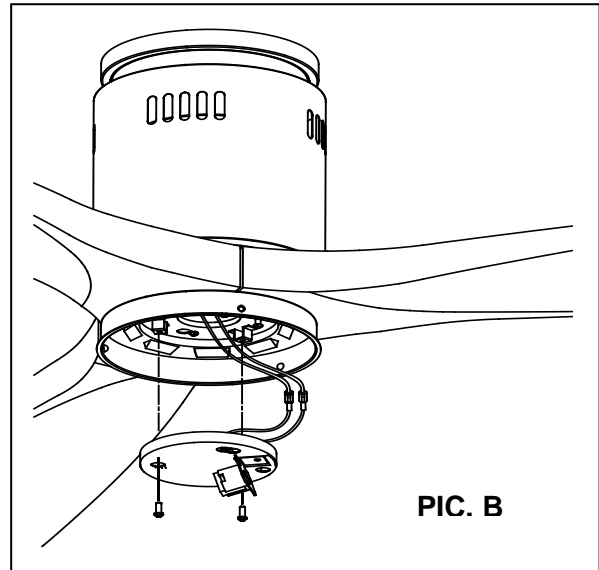
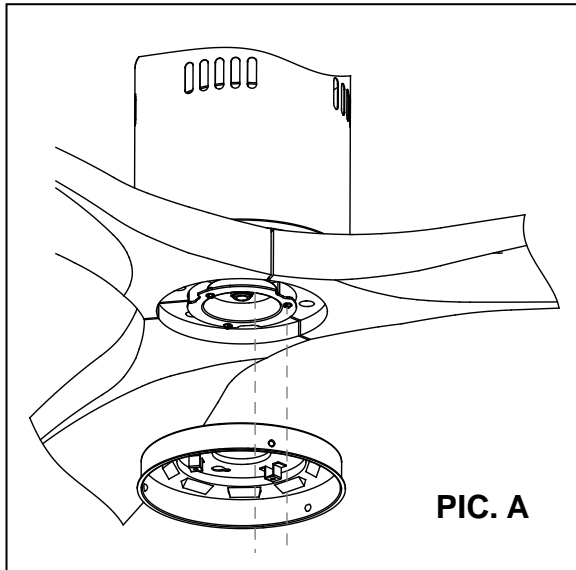

Release three screws on the bottom of switch box, put light fitter onto switch box, using three screws to fasten light fitter. (See PIC. A), Connector earth wire of light fitter to earth wire from switch box. Release three screws on the light fitter, connect push plug white to white, black to black, put socket fitter onto light fitter and fasten it with three screws, please make sure both fitter tighten enough. (See PIC. B)

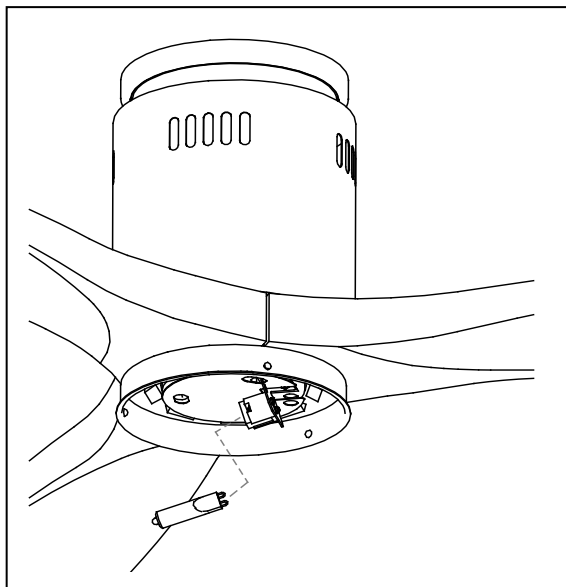

Your fan is supplied with one G9 60W, Install G9 bulb to socket after socket fitter installation finished. Please do not touch bulb with your finger, it may cause the bulb to fail.

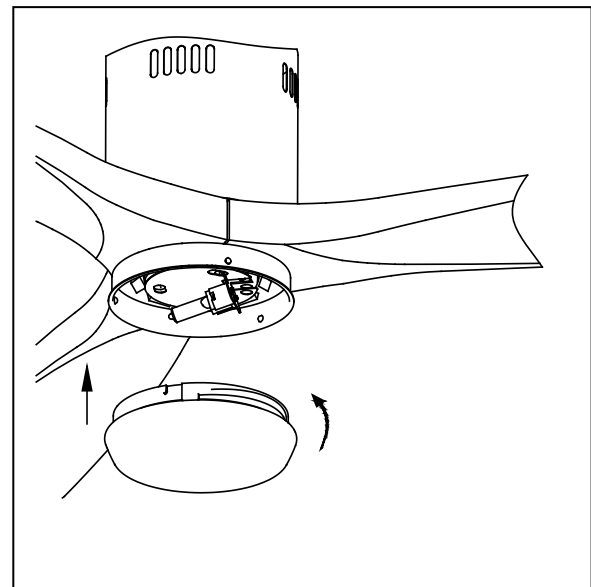

Put the glass up to fitter and twist it tight.

**After connecting all the wire and assembly the blades and light kit, it is a good time to test that the fan and remote control operates correctly.**

**Please refer next page for R.C. setup before turn on the power.**

## 5-1 Attaching the LED light fitter and glass to the Fan

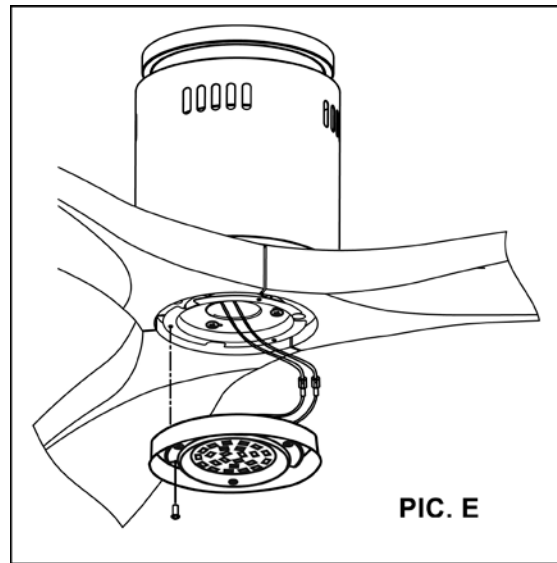
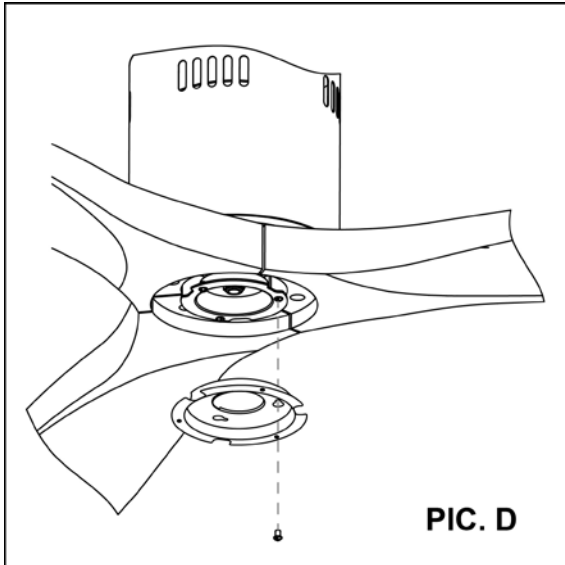

Release three screws on the bottom of switch box, put light fitter onto switch box, using three screws to fasten light fitter. (See PIC. D). Release three screws on the light fitter, connector earth wire of LED light kit to earth wire from switch box., connect push plug of LED light kit to the push plug from fan. (See PIC. E). Carefully to put all the wires into light fitter, then put LED light kit onto light fitter and fasten it with three screws, please make sure both fitter tighten enough.

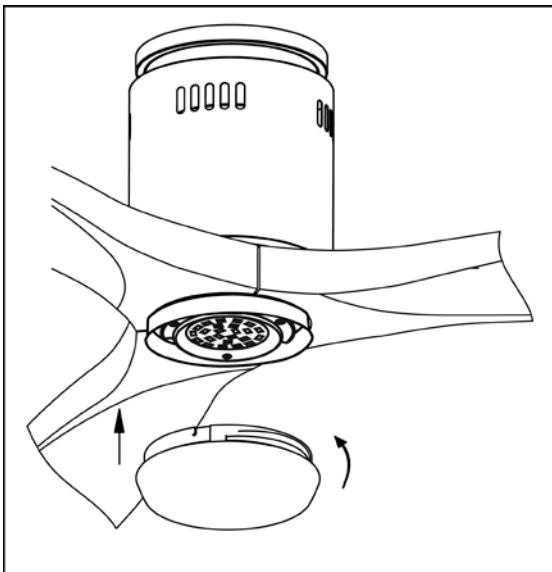

Put the glass up to fitter and twist it tight. Now your LED light kit is installed completely.

**NOTED: LED light kit is ON/OFF only  
no Dimmer.**

**After connecting all the wire and assembly the blades and light kit, it is a good time to test that the fan and remote control operates correctly.**

**Please refer next page for R.C. setup before turn on the power.**

## 6. SET UP THE REMOTE CONTROL

### **IMPORTANT : DC MOTOR INITIAL SETUP PROCEDURE.** **THIS STEP MUST BE PREFORMED BEFORE** **YOUR FAN WILL OPERATE**

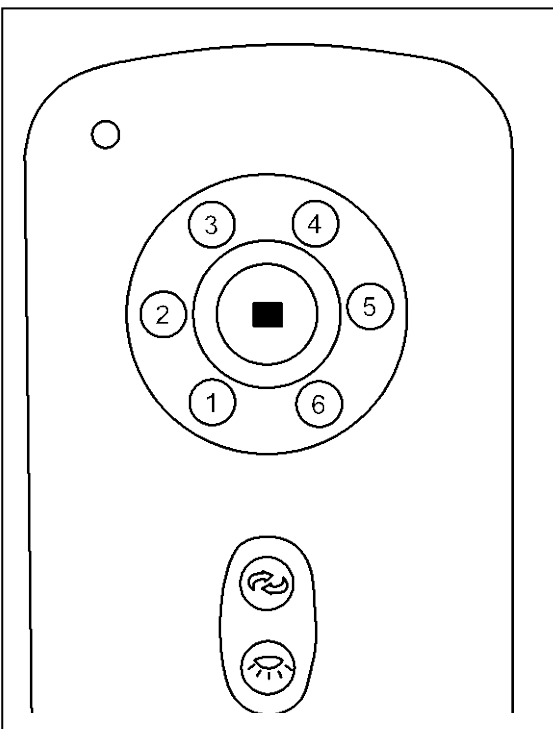
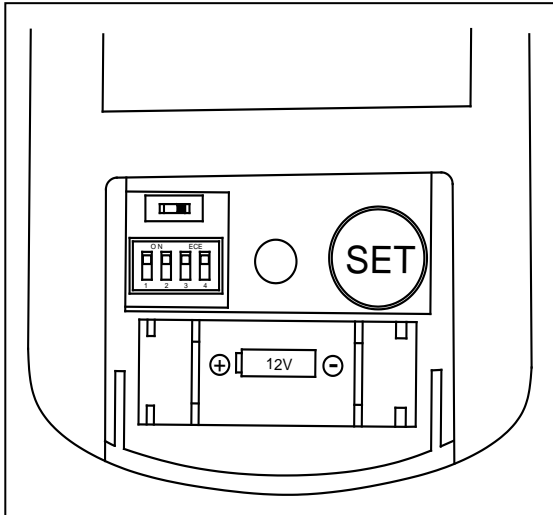

1. Set the dip switches with different code which is at inside the battery compartment door of the hand set transmitter if you have more than one set fan to be operated at same room.
2. Within 60 seconds of turning power on to the unit, press the “SET” button (also inside the battery compartment door) for 5 seconds or until the lights blink twice.
3. Press Button 6 (High Speed) button and let the unit run for 120 seconds. This is necessary for the electronics to calibrate each speed/RPM based on the load of the blades.
4. After 120 seconds, reverse the fan and press Button 6 (High speed) button in the upflow direction to accomplish the same endeavor.
5. After the above 4 steps are completed the fan should be ready to operate normally at any speed.
6. The dip switch “D” and “ON” is for setting up the operation of the light kit. In the ‘ON’ position the dimmer will operate. In the ‘D’ position the light will only operate in on/off mode.
7. Please note – This switch must to the D position for LED lighting. If left in the ON position and LED light used there may be damage to the control system

**NOTE:** If the power is interrupted or turned off by a wall switch, the fan will run through an automatic set up procedure. The fan will start to run at high speed for approximately 120 seconds, then drop to the speed you have pushed on the transmitter or the speed that it was set to before power was disconnected.

## HOW TO OPERATE THE HANDSET (TRANSMITTER)

The wireless remote control is designed to control all commonly used features include the airflow upward and downward reversing function.

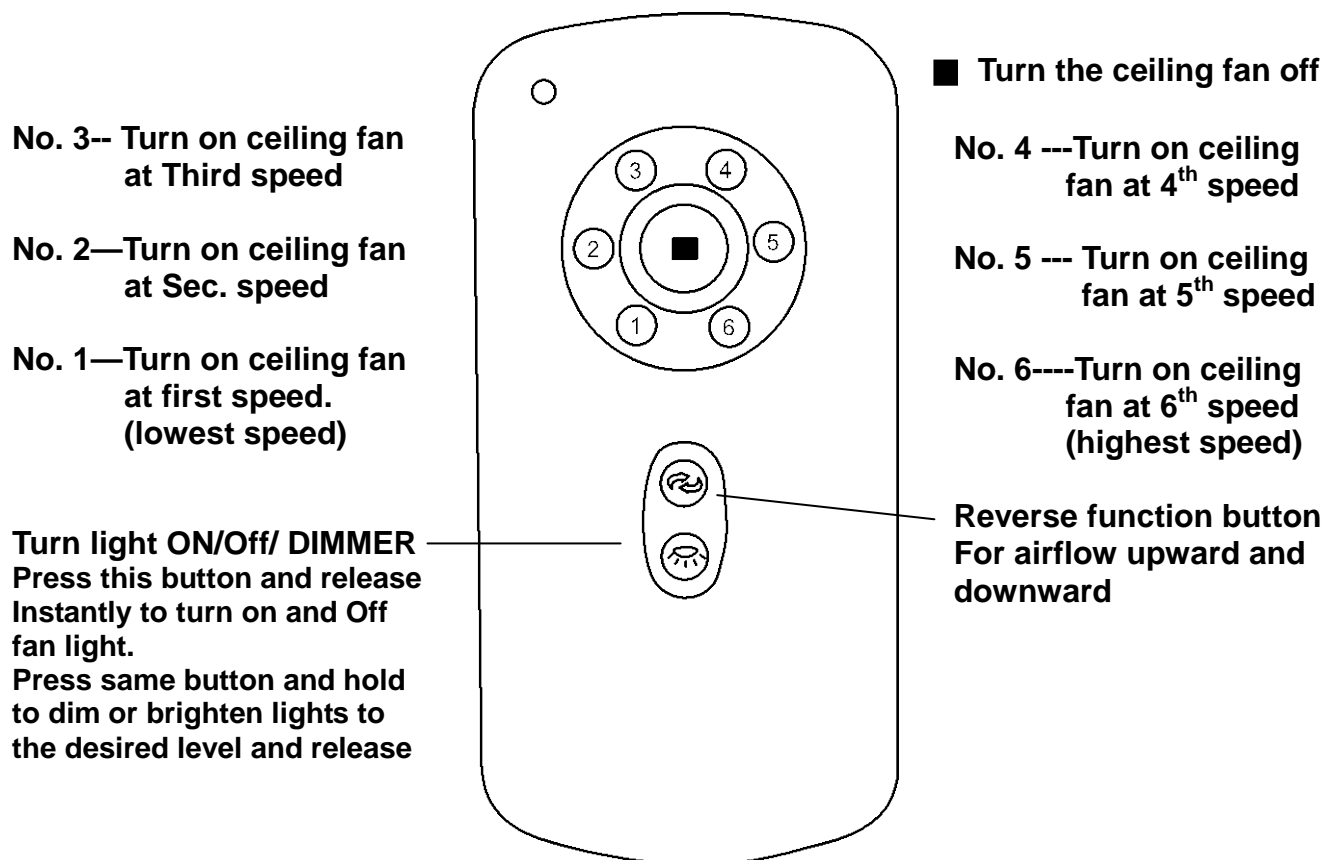

The battery should be changed to a new one.

**Battery Replacement:**

**12V Battery A23 or equivalent**

### NOTE :

1. Please allow a moment between each operation.
2. Please handle the transmitter with care, be sure not to drop or expose it to water, high humidity or place where is too close to a heating element. Improper handling may result in malfunction and void the warranty.
3. The remote control is operated by Radio Frequency, so, it won't be necessary to point this unit at the ceiling fan while activating the handset functional button.

## Blade balancing

Whilst every precaution is taken at the factory to ensure your fan is of the highest quality, imbalance may occur. This may be due to slight irregularities in the blades or blade carriers. Deviating from these instructions can cause further problems.

The following procedure may help to rectify the situation.

The hanging bracket must always be tight against the ceiling so that no movement can occur.

Check all the blades are firmly tightened on to their carrier brackets.

Changing over two adjacent blades – may correct any imbalance.

Use the universal balancing kit supplied with the fan.

## Product Disposal Instructions

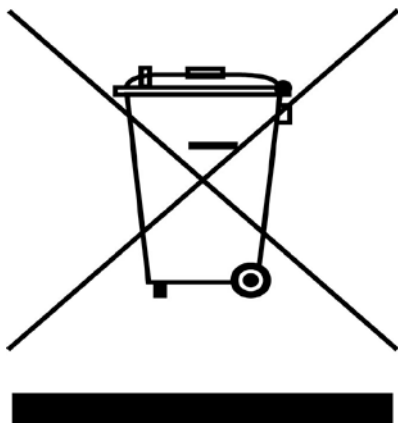

This product has been classed as Electrical or Electronic Equipment and should not be disposed of with other household or commercial waste at the end of it's working life.

The Waste of Electrical and Electronic Equipment (WEEE) Directive (2002/96/EC) has been put in place to recycle products using best available precise and minimize the impact upon the environment.

## **Ceiling Fan Warranty.**

You must have the original purchase receipt or bill of sale to make a warranty claim. No claim will be accepted unless proof of date of purchase is available at the time of making the warranty claim.

### **Ceiling Fan Warranty Period.**

The ceiling fan itself, excluding accessories such as the Remote Control Transmitter and Receiver, is covered by a 15 year warranty. During this period, Fantasia Distribution Ltd will, at its discretion, repair or replace defective product. During this 15 years, the owner is responsible for labour costs incurred in removing and re-installing the fan, and for transport costs to Fantasia Distribution Ltd's repair centre. Return freight will be paid by Fantasia Distribution Ltd. The cost of obtaining or using special access equipment (scissor lifts, scaffolding etc.) is specifically excluded, and it is the responsibility of the owner to provide such equipment and have it safely installed and operated.

### **Remote Control Warranty Period.**

Fantasia Distribution Ltd's Remote Control Receivers and Transmitters (Handsets) are covered by a 2 year repair or replacement warranty

### **Balance of Warranty on Repaired or Replaced Products.**

Any replaced or repaired product is covered only by the balance of the warranty remaining on the original article.

### **Transfer of Warranty.**

If the dwelling where the fan or remote control is installed changes hands, the balance of the warranty passes to the new owner, providing the original bill of sale for the product is retained by the new owner.

Warranty for the fan does not cover damage to the fan if it is moved from one dwelling to another during the warranty period. The warranty is voided in total if the product is sold as second hand goods.

### **The following is NOT covered by warranty.**

1. Any damage incurred after delivery to the owner that is not caused by a fault in the products materials or workmanship; damage from lightning or power surges; incorrect installation; damage due to incorrect installation; water damage of any kind; installation or use outdoors; damage arising from connection to or use with alternative power systems (e.g. inverters, solar, etc.).
2. Ceiling fans not installed by a qualified electrician.
3. Repair of a ceiling fan used incorrectly, accidentally damaged, modified in any way or not serviced in accordance with the maintenance instructions.
4. The cost of transporting and insuring the ceiling fan between the nearest Fantasia Distribution Ltd agents' service depot and its normal location.  
These costs must be met by the purchaser
5. Subject to any statutory provisions to the contrary, claims for damage to furniture, carpet, walls, ceilings, foundations or any other consequential loss either directly or indirectly resulting from a faulty ceiling fan.
6. Ceiling Fans not purchased and installed in Mainland UK.
7. A service fee will be charged where; there is nothing wrong with the ceiling fan or; the defective operation of the ceiling fan is due to failure of electricity or; the installation is not in accordance with Fantasia Distribution Ltd instructions and/or applicable local regulations or; the defects have been caused by incorrect application or abuse of the ceiling fan or; the damage has been caused by unauthorized persons attempting to repair the fan.

# -----NOTE-----



# -----NOTE-----



132cm/52"

# Zeta

**FANTASIA DISTRIBUTION LTD.**

**Unit B. The Flyers Way, Westerham, Kent, TN16 1DE**

**Tel : (01959) 564 440 Fax : (01959) 564 829**

**E-MAIL: [info@fantasiaceilingfans.com](mailto:info@fantasiaceilingfans.com)**

## Fantasia ceiling fans - Warranty Activation Form

To activate your warranty please complete this form, and post it back to us at Fantasia

Name.....

Address.....

Town.....

Post Code.....

Email.....

Purchased from.....

Date Installed.....

Please tick this box if you would like to receive updates on:

The Fantasia Elite Range ☐

The Fantasia Standard Range ☐

**1. How did you first hear about Fantasia Ceiling Fans?**

Shop Display ☐

Brochure ☐

Friend's Recommendation ☐

Web Search ☐

Other.....

**2. In which room is your fan installed?**

.....

**3. What do you think would be a good name for a ceiling fan?**

.....

\*£50 to the owner of any suggestions used!

**4. Do you consider a ceiling fan to be a good alternative to air conditioning?**

Yes ☐

No ☐

**5. Do you intend to use the reverse function of your ceiling fan in Winter?**

Yes ☐

No ☐

**6. What do you like most about Fantasia Ceiling Fans?**

.....

Thank you for answering these questions.  
Your answers will help us excel in customer service and product development

**I have read the terms of the warranty and agree to adhere to them**

Print.....

Signed.....

Date.....





132cm/52"

# Zeta

Please cut out this warranty page and send it in an envelope to the address below.

Alternatively please go to our website [www.fantasiaceilingfans.com](http://www.fantasiaceilingfans.com) and fill in the warranty section there.

**FANTASIA DISTRIBUTION LTD.**

Unit B. The Flyers Way, Westerham, Kent, TN16 1DE

Tel : (01959) 564 440 Fax : (01959) 564 829

E-MAIL: [info@fantasiaceilingfans.com](mailto:info@fantasiaceilingfans.com)