

BLADE

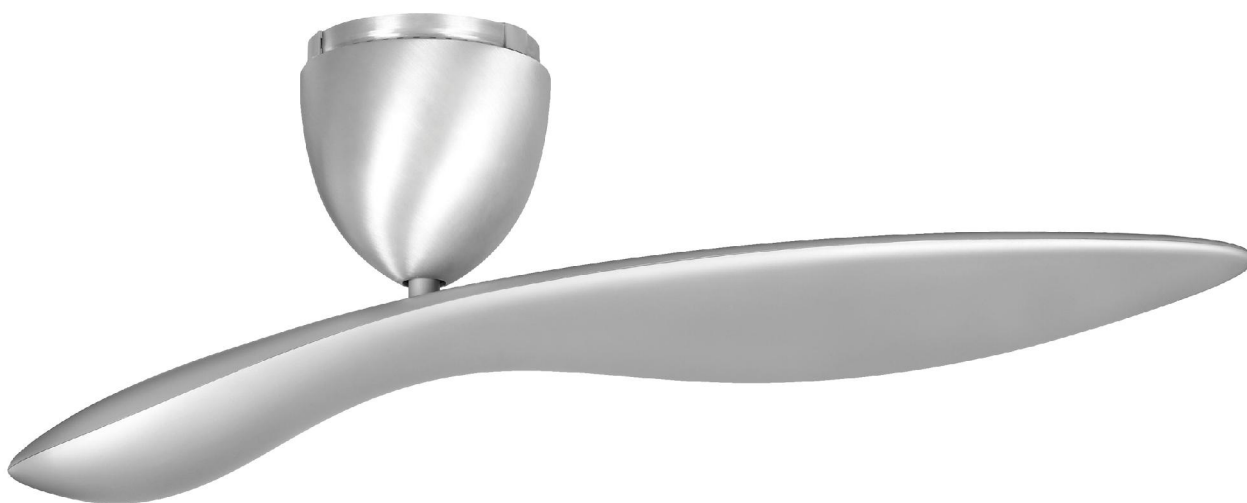

Owners Installation Manual

Please ensure that this manual is retained
and held at the installation site.

BLADE

Table of Contents

Section 1	Introduction
Section 2-3	Important Safety Precautions

Instructions for Flush Mount Installation

Section 4-5	Unpacking Your Blade Fan
Section 6	Preparing Ceiling
Section 7	Installing Hanger Bracket
Section 8	Making Hanger Bracket Electrical Connections
Section 9	Preparing Fan Motor Assembly
Section 10	Installing Fan Motor Assembly
Section 11	Making Fan Motor Assembly Electrical Connections
Section 12-14	Setting Accessory Remote Control Codes
Section 15	Installing Accessory Remote Control Receiver
Section 16-18	Making Remote Control Receiver Electrical Connections
Section 19	Accessory Remote Control Installation Diagram
Section 20-22	Preparing and Installing Fan Motor Housing
Section 23-25	Preparing and Installing Fan Blade
Section 26	Installation Check
Section 27	Operating Your Blade Fan
Section 28	Care and Cleaning
Section 29	Trouble Shooting
Section 30	General Information on Ceiling Fans
Section 31	Technical Specifications
Section 32-33	Warranty

Instructions for Suspended Installation

Section 34	Unpacking Your Blade Fan Suspension Kit
Section 35-36	Preparing Fan Motor Assembly
Section 37	Preparing Suspension Rod
Section 38	Attaching Suspension Rod to Suspension Cover
Section 39	Attaching Suspension Rod to Fan Motor Assembly
Section 40-42	Making Fan Motor Assembly Electrical Connections
Section 43-44	Attaching Canopy and Suspension Ball to Suspension Rod
Section 45	Installing Fan Motor/Suspension Rod Assembly
Section 46	Installing Accessory Remote Control Receiver
Section 47-49	Making Remote Control Receiver Electrical Connection
Section 50-51	Installing Canopy
Section 52	Preparing and Installing Fan Motor Housing
Section 55	Product Disposal

BLADE

1 Introduction

Thank you for choosing a Blade Ceiling Fan. You have chosen the best! We are confident that your new ceiling fan will provide many years of service and enjoyment.

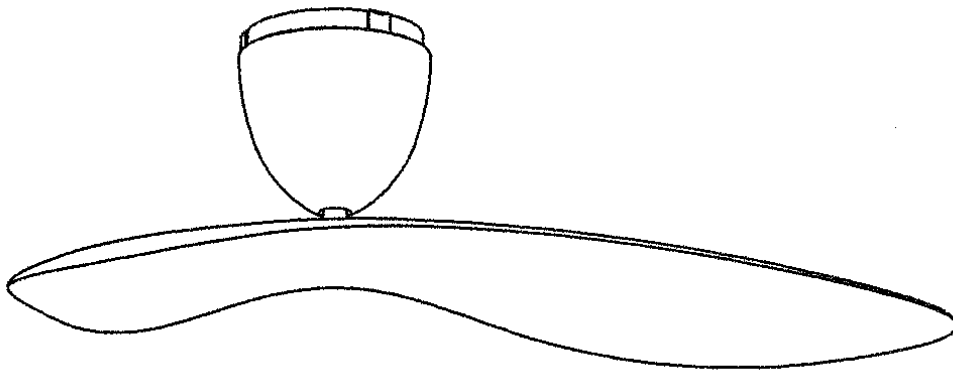

GENERAL PRECAUTIONS

Please read and follow these instructions carefully, and be mindful of all warnings shown throughout this manual.

Be cautious! Read all instructions and safety information, and review the accompanying assembly diagrams before installing your new fan.

Electricity can kill. Please ensure household supplies are fully disconnected before installing or carrying out maintenance on this product.

Close supervision is necessary when the product is used by children. Do not allow children to use it as a toy.

2 Important Safety Precautions

LOCATION AND INSTALLATION REQUIREMENTS FOR YOUR FAN

To provide adequate clearance from the floor the lowest point on the fan blade must be at least 2.3 m (7'6") from the floor.

Note - For a fan mounted directly to the ceiling, the lowest point of the fan blade is approximately 365mm (14¼") below the ceiling,

Note - For a fan mounted on a suspension kit, the lowest point of the fan blade is approximately 375mm (14¾") plus the nominal length of the suspension rod below the ceiling

Make sure that the chosen location of the fan will not allow the rotating fan blade to come into contact with any object.

Ensure ceiling joists are sound and of adequate size and strength to support a 86Kg (190lb) load.

To reduce the risk of fire, electrical shock or personal injury, ensure that the fan mounting bracket is supported directly from the building structure, DO NOT mount to an outlet box.

The mounting bracket must be firmly screwed to a load bearing structure e.g. a concrete ceiling, steel structure or timber frame. If a timber frame is to be added it must be securely nailed or screwed between two beams.

MECHANICAL ISSUES

Do not remove the fan from the ceiling after installation.

Do not attach the Fan Blade before the Fan Motor Housing is installed and secured.

To protect the finish, the Fan Blade and the Fan Motor Housing should be kept in their cartons until ready to be installed.

After the fan is completely installed, check to make sure that all connections are secure to prevent the fan from falling and/or causing damage or injury.

To reduce the risk of personal injury, do not bend or damage the Motor Drive Shaft or Fan Blade when handling or installing them.

3 Important Safety Precautions

ELECTRICAL ISSUES

The fan and hanger bracket must be earthed.

Do not attempt to control the operation of this fan from any wall controller that is not approved by Fantasia Distribution Ltd for use with this fan.

DO NOT use a solid state wall controller.

The use of an unapproved control system voids the warranty.

To avoid possible electric shock during installation, be sure the electricity is turned off at the main fuse box before commencing work.

Disconnect power by removing fuse or turning off circuit breaker before installing the fan.

Ensure all spliced connections are adequately insulated.

NOTE

Nothing in this manual is intended to instruct or assist untrained or unqualified persons to install this product. Additionally, it is the responsibility of the installer and user to apply common sense and care at all times.

BLADE

4 Unpacking your Blade Fan

Unpack your fan and check the contents. You should have two cartons - a Motor Carton and a Blade Carton. Do not discard the cartons. If warranty replacement or repair is ever necessary, the fan should be returned in the original packaging.

Examine all parts. You should have the following:



Hanger Bracket
x 1 unit

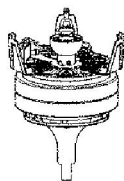

Fan Motor Assembly
x 1 unit

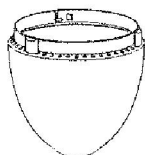

Fan Motor Housing
x 1 unit



Fan Blade
x 1 unit

Hanger Bracket Hardware



Screw
x 2 units

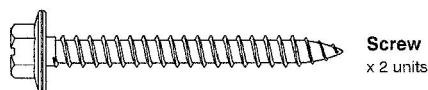

Screw
x 2 units

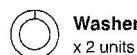

Washer
x 2 units



Washer
x 2 units

Blade Hardware



Screw
x 2 units (1 + 1 Spare)

BLADE

5 Unpacking your Blade Fan

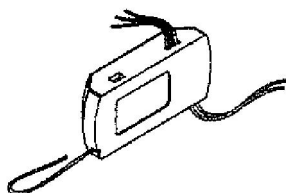

Remote Control Receiver
x 1 unit



Remote Control Transmitter
x 1 unit



Battery
x1 unit

Note:

Remote Control Transmitter may vary from one shown.



Warning: Do not attempt to control the operation of this fan from any control system that is not approved by Fantasia Distribution Ltd for use with this fan. Do not use a solid state wall controller. The use of an unapproved control system voids the warranty.

6 Checking Ceiling Condition and Preparing for Fan Installation



Before commencing installation, turn off electricity supply at the main power box. Disconnect power by removing fuse or turning off circuit breaker before commencing work.

Installation directly mounted to Ceiling Joist

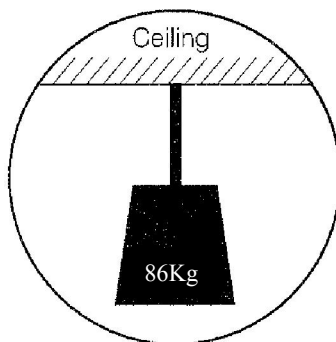
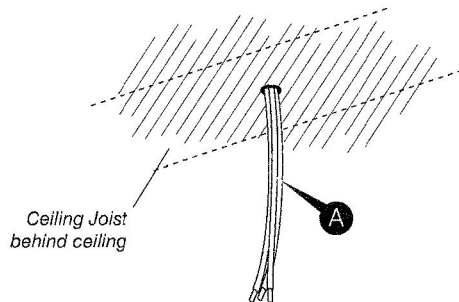

Check that the mounting location is of adequate strength to support the fan.

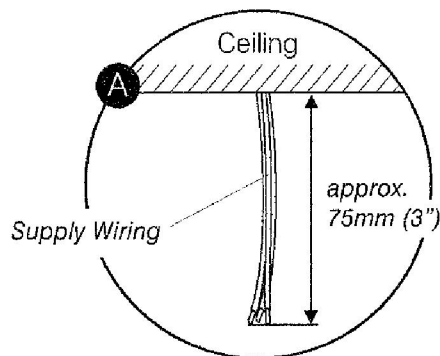

Ensure the Supply Wiring is of sufficient length.

7 Attaching Hanger Bracket directly to Ceiling

Drill holes in Ceiling Joist at approximately 90mm (3 1/2") centres for Hanger Bracket mounting.

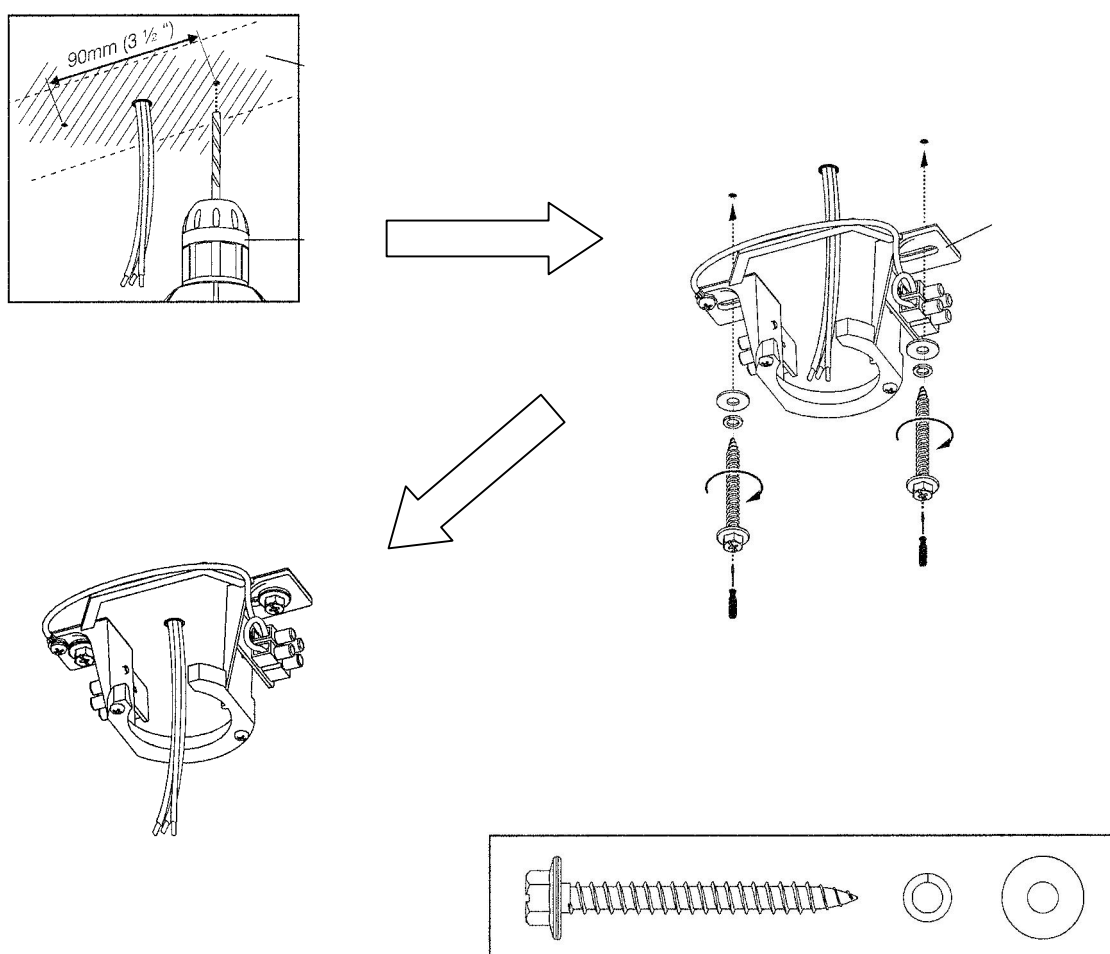

Secure Hanger Bracket to Ceiling Joist using screws and washers provided. Ensure screws are securely tightened.

8 Connecting Live, Neutral and Earth Wires from Supply

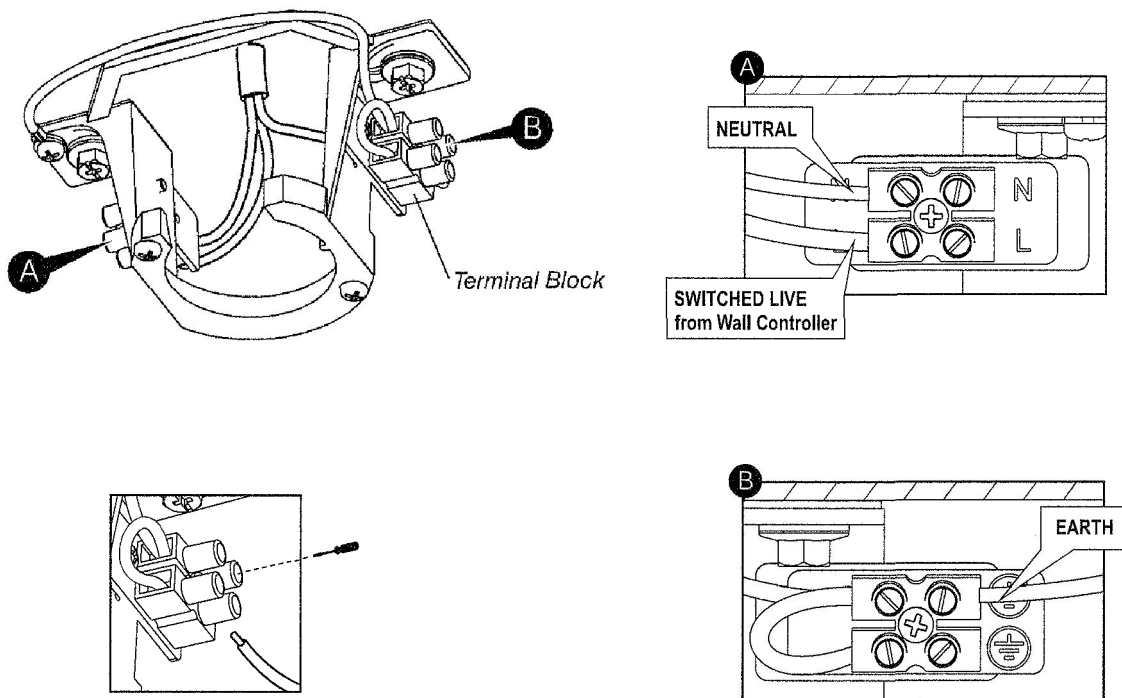

Ensure that electrical connections are good and that terminal block screws are secure.

Make NEUTRAL (Blue or Black) and EARTH (Green & Yellow) connections from incoming Mains supply to NEUTRAL and EARTH terminals on Hanger Bracket as appropriate.

Make SWITCHED LIVE (Brown or Red) connection from Wall Switch to LIVE terminal on Hanger Bracket. This wire could also be Blue or Black with a Brown or Red marking.

BLADE

9 Preparing Fan Motor Assembly for Flush Mount Installation

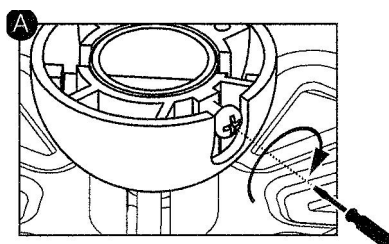

Check that the Suspension Ball fixing screw is securely tightened.

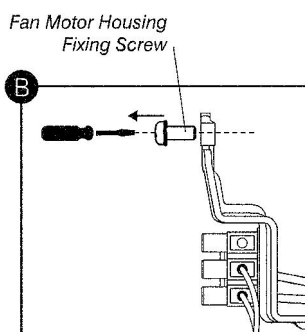
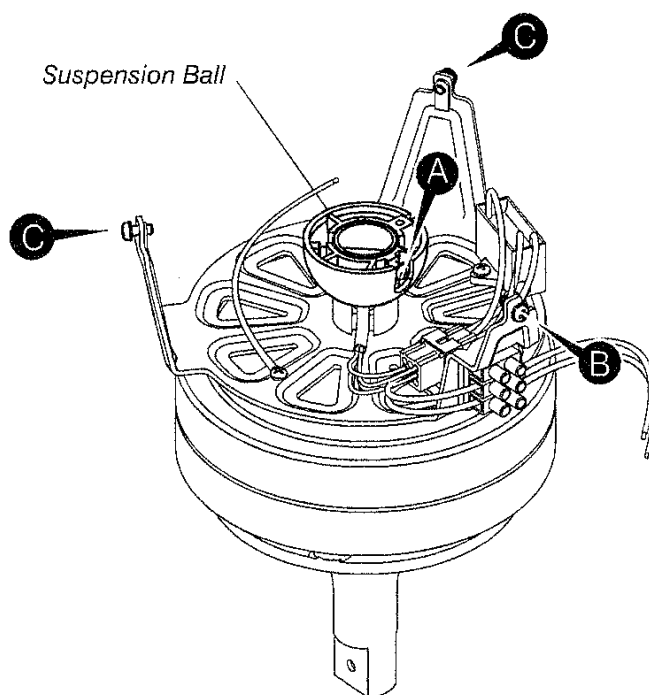

Remove one Fan Motor Housing fixing screw, and put it aside for re-assembly during Fan Motor Housing installation.

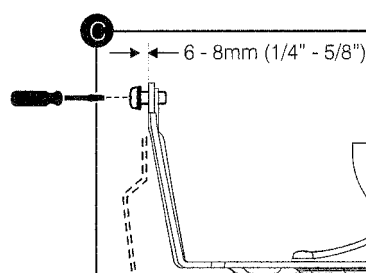

Adjust remaining two Fan Motor Housing fixing screws to provide clearance for installing Fan Motor Housing.

10 Installing Fan Motor Assembly into Hanger Bracket

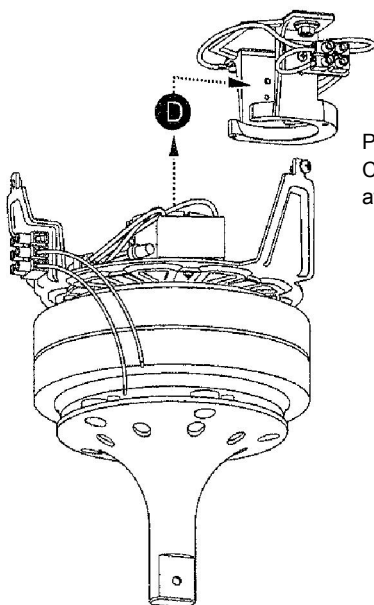

Position Fan Motor Assembly so that Chassis arm with terminal block is facing away from opening in Hanger Bracket.

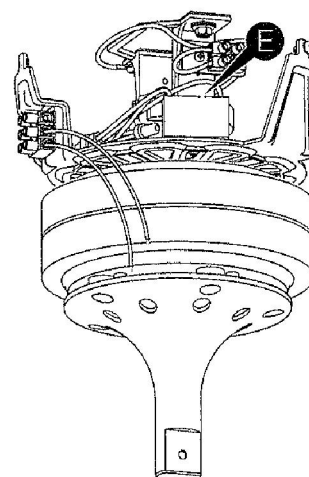

Locate Suspension Ball in Hanger Bracket.

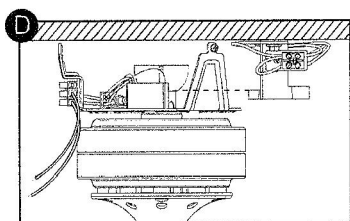

Take care to keep Fan Motor Assembly level during installation to avoid marking ceiling.

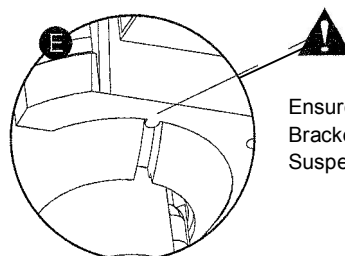

Ensure that lug on Hanger Bracket is engaged in slot in Suspension Ball.

11 Connecting Earth Wire from Fan Motor Assembly to Hanger Bracket

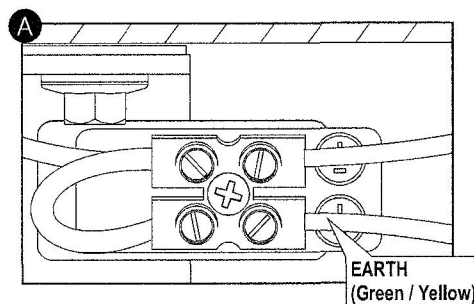
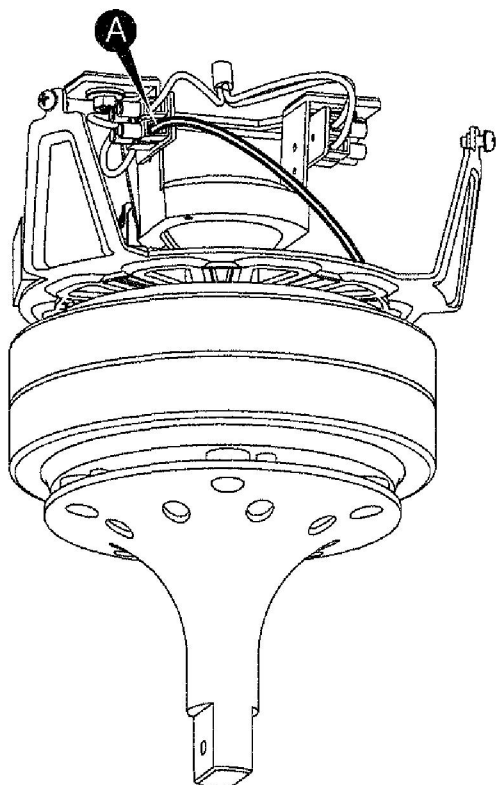

Make EARTH (Green/Yellow) connection from Fan Motor Assembly to appropriate terminal on Hanger Bracket.

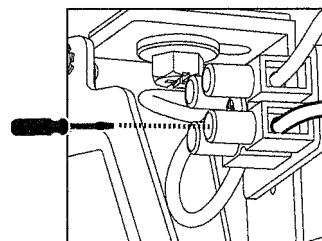

Ensure electrical connections are good, and that terminal block screws are secure.

BLADE

12 Setting Code Switches for Remote Control Handset and Installing Battery

Check Remote Control Transmitter (Handset) CODE switch settings are identical to Receiver CODE switch settings (use point of ball point pen to adjust switches).

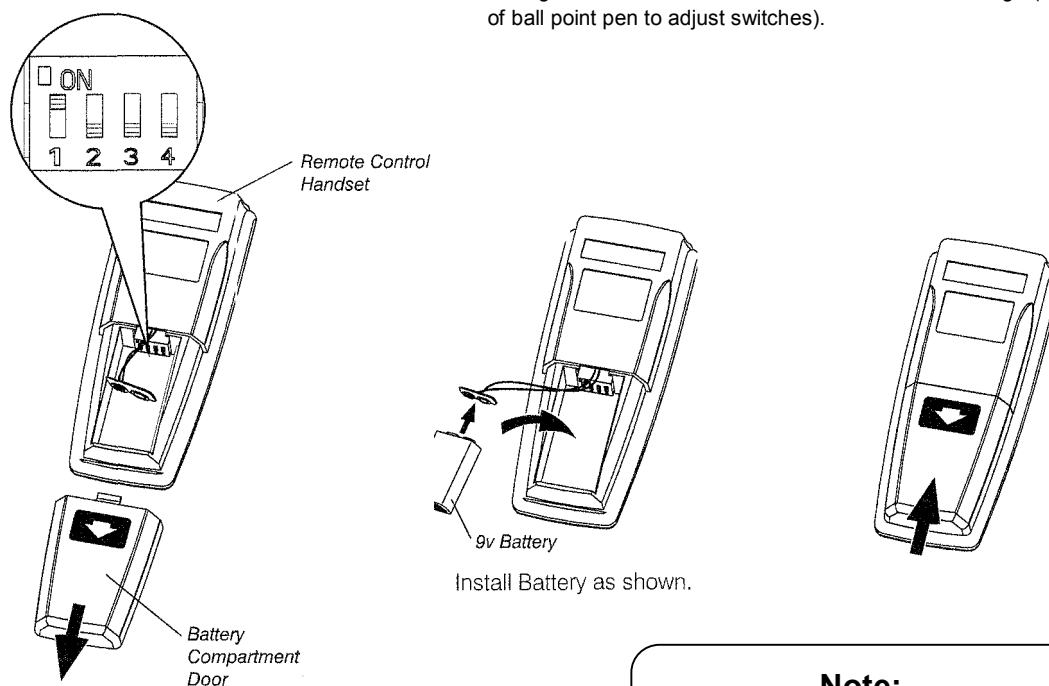

Note:
Remote Control Transmitter
may vary from one shown.

13 Setting Code Switches for Remote Control Receiver

Check Remote Control Receiver CODE switch settings and adjust if required (use point of ball point pen to adjust switches).

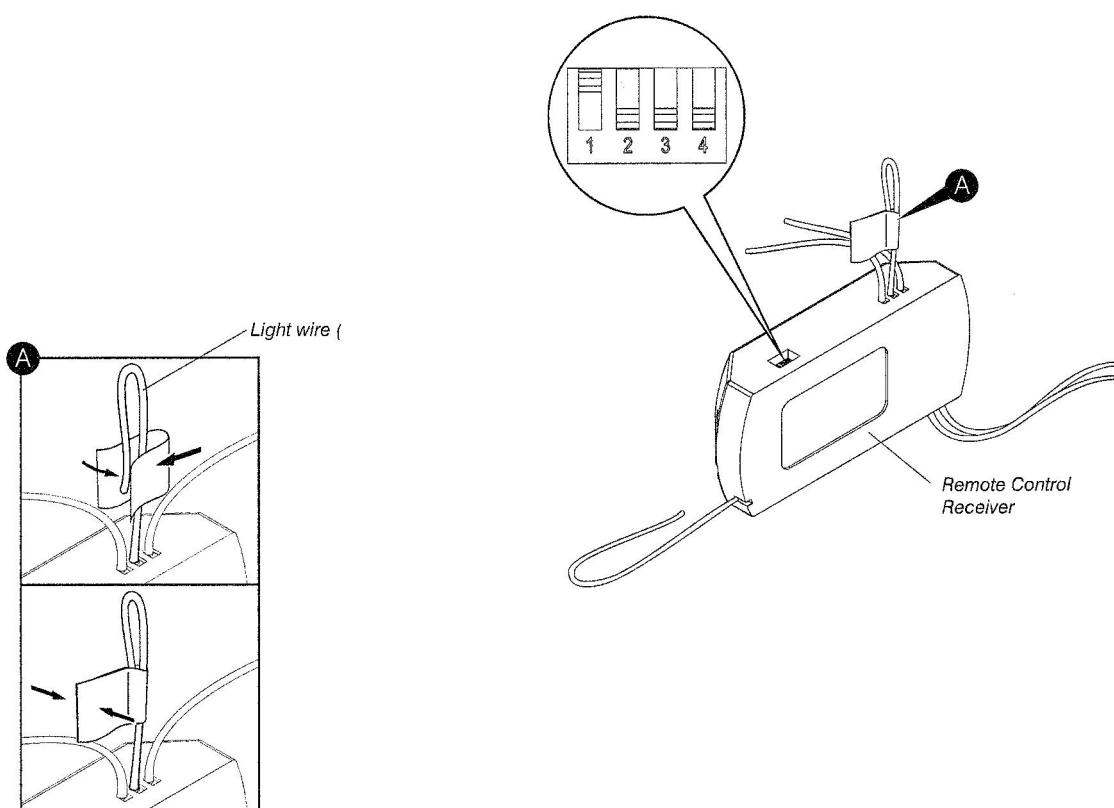

Terminate Remote Control Receiver light wire (marked LIGHT OUT) using good quality electrical insulation tape as shown,

14 Code Settings for Remote Control Handset and Receiver

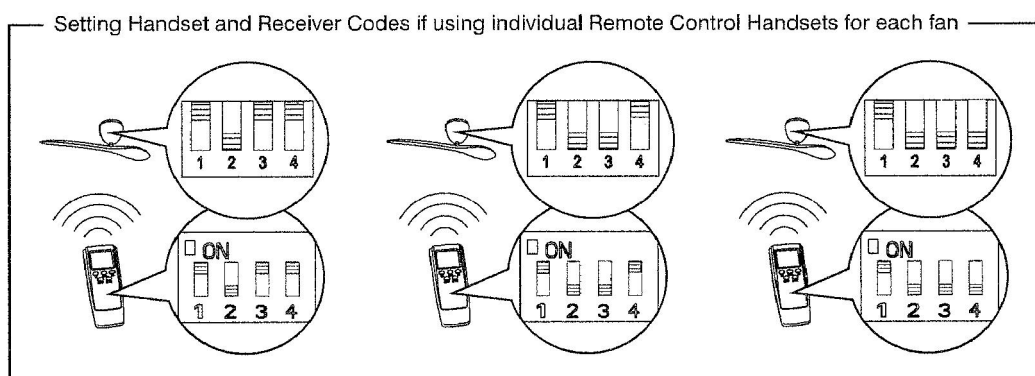
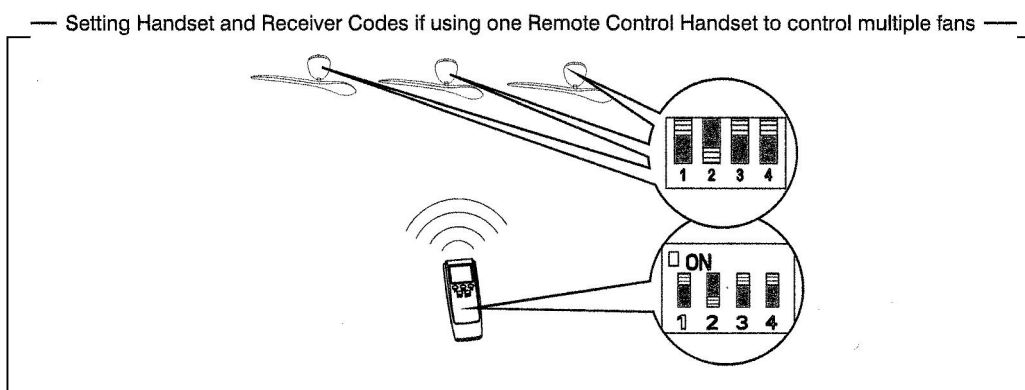

Note: Ensure that the maximum distance from the Remote Control Handset to Receiver does not exceed the range of the transmitter.

15 Installing Remote Control Receiver in Hanger Bracket

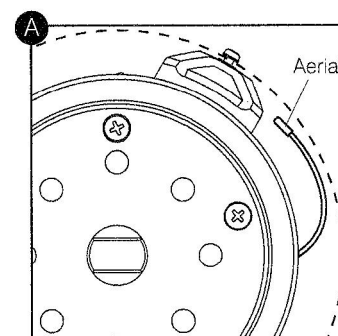
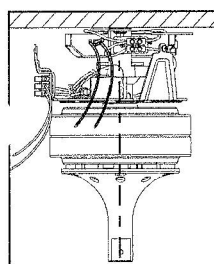
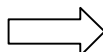
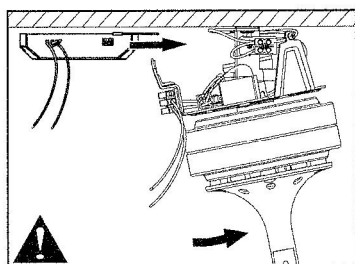
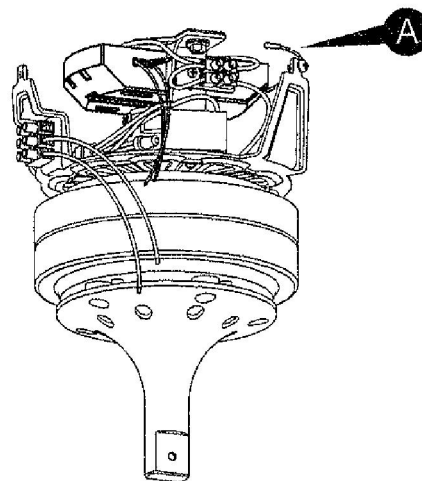
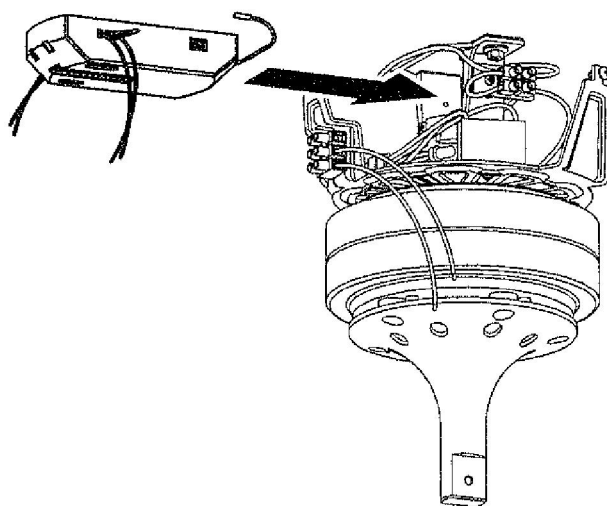

Tilt Fan Motor Assembly as shown and slide Remote Control Receiver into Hanger Bracket in orientation shown (Code switches to be passed through Hanger Bracket).

After installing Remote Control Receiver readjust Fan Motor Assembly to ensure Drive Shaft is vertical.

Fix Remote Control Receiver Aerial to ceiling within circle of Fan Motor Housing.

16 Removing pre-installed Live and Neutral Wires from Fan Motor Assembly

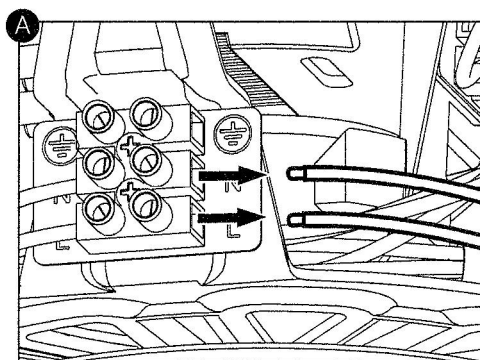
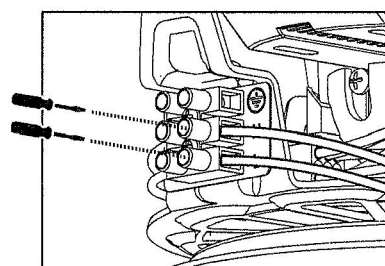
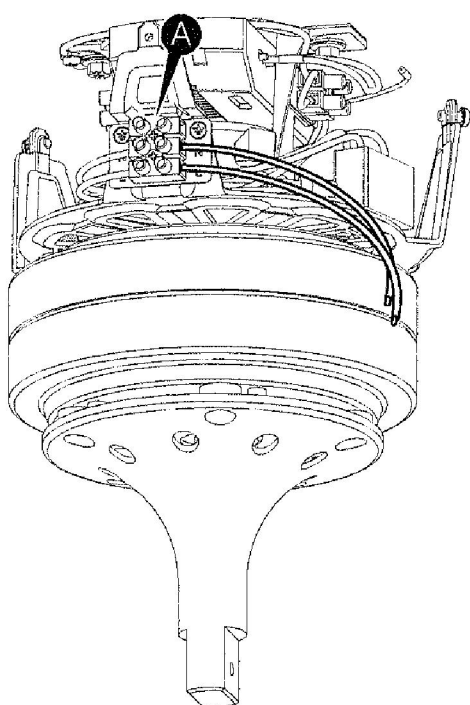

Remove pre-installed LIVE (Brown) and NEUTRAL (Blue) wires from right side of terminal block on Fan Motor Assembly,

17 Connecting Live and Neutral Wires from Remote Receiver to Bracket

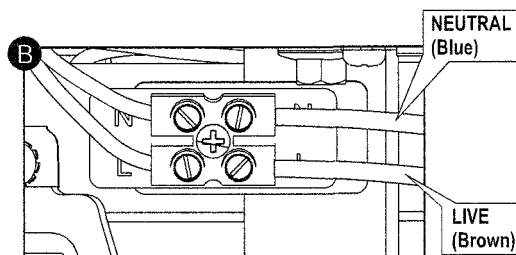
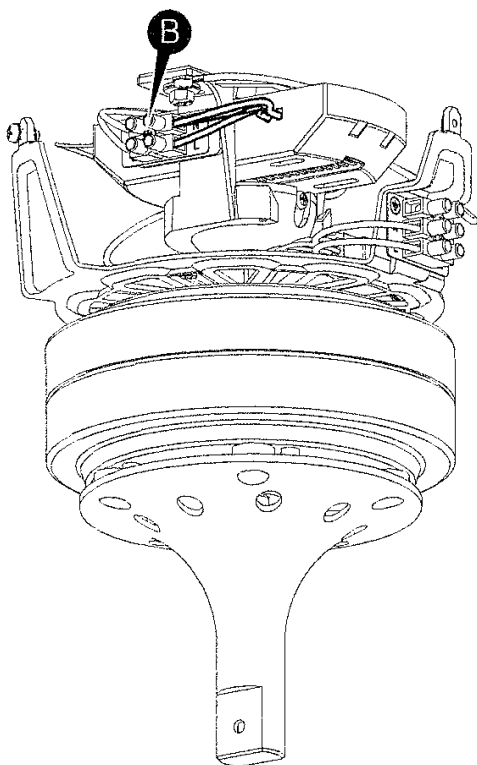

Make LIVE and NEUTRAL connections from Remote Control Receiver to appropriate terminals on Hanger Bracket using wires marked LIVE IN (Brown) and NEUTRAL IN (Blue).

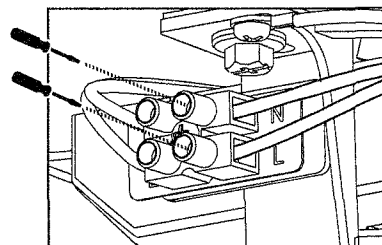

Ensure that electrical connections are good, and terminal block screws are secure.

18 Connecting Live and Neutral Wires from Remote Receiver to Motor Assembly

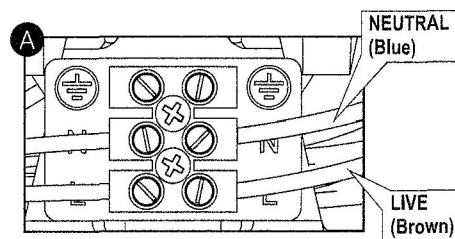
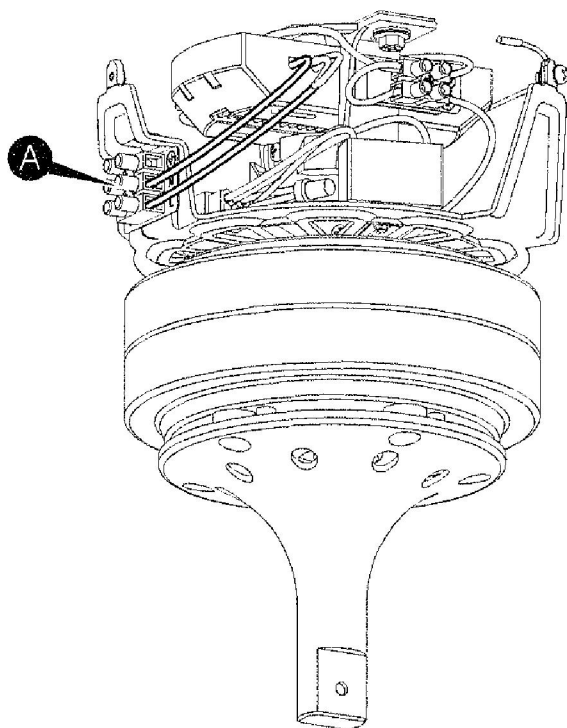

Make LIVE and NEUTRAL connections from Remote Control Receiver to appropriate terminals on Fan Motor Chassis using wires marked L (Brown) and N (Blue).



Ensure Remote Control Receiver LIGHT Wire is well secured and cannot touch any moving parts.

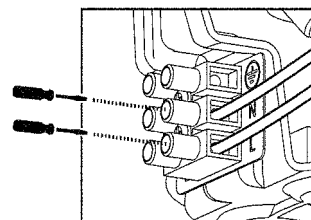

Ensure that electrical connections are good, and terminal block screws are secure.

19 Remote Control (Accessory) Installation Wiring Diagram

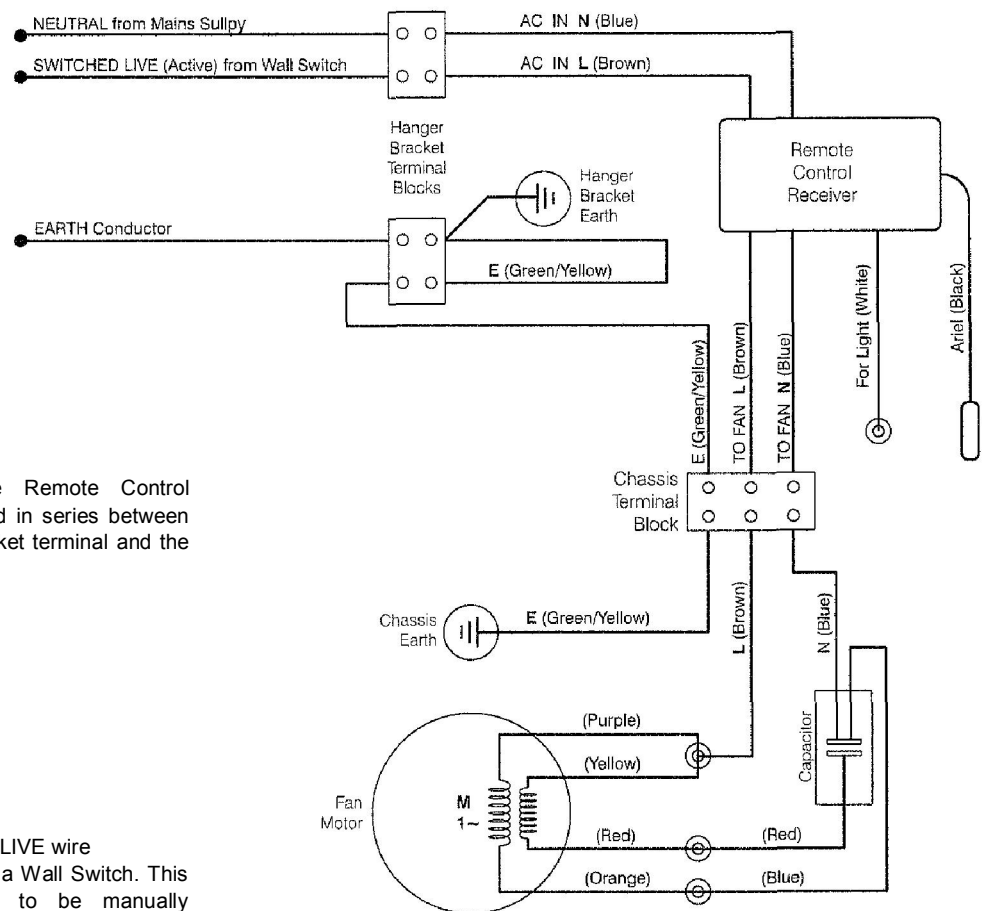

Note:

As shown, the Remote Control Receiver is wired in series between the Hanger Bracket terminal and the Chassis terminal.



The SWITCHED LIVE wire **MUST** come via a Wall Switch. This allows the fan to be manually switched off, should a fault ever develop.

20 Preparing Fan Motor Housing

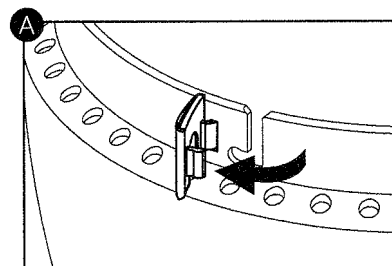
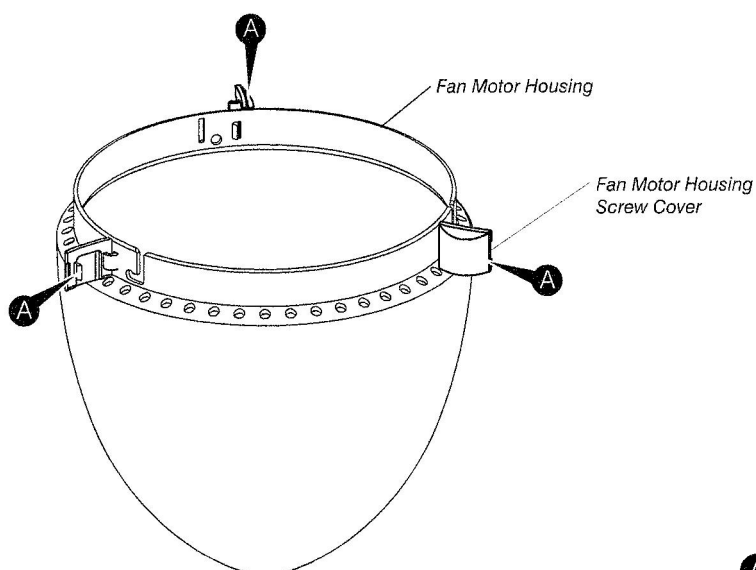

Ensure Fan Motor Housing Screw Covers are in fully open position.

21 Attaching Fan Motor Housing to Fan Motor Assembly

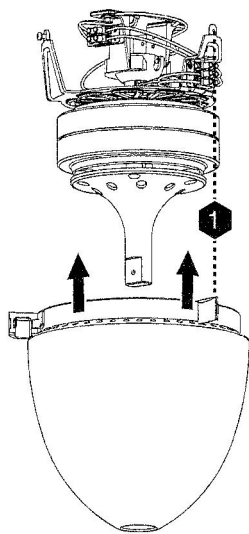

Ensure that Fan Motor Housing fixing point with hole (not bayonet slot) is aligned with Chassis arm from which fixing screw was removed (see page

Install Fan Motor Housing using a clockwise bayonet action

Line up fixing hole in Fan Motor Housing with screw hole in Chassis arm and install fixing screw removed on page

Secure Fan Motor Housing, ensuring all three screws are tight but not over tight.

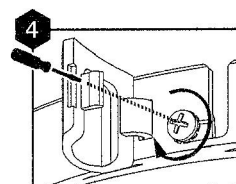
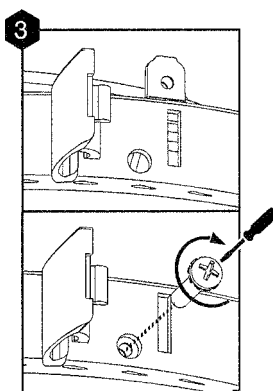
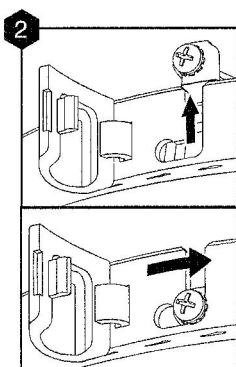

22 Closing Screw Covers

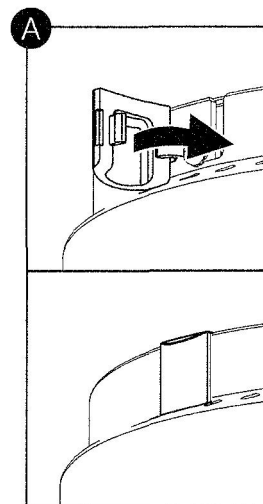
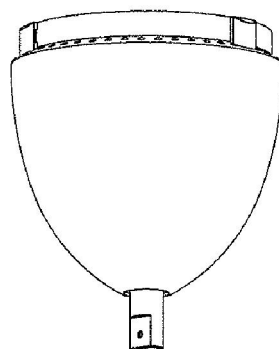
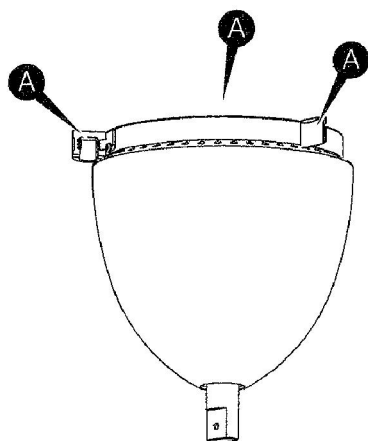

Close all three Screw Covers.

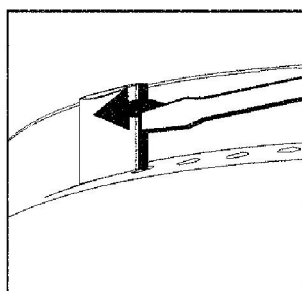

Note: To remove Fan Motor Housing open Screw Covers using a flat bladed screw driver as shown. Remove fixing screw from hole, loosen two bayonet slot screws and remove Fan Motor Housing by rotating anticlockwise and lowering.



Fan Blade must be removed before Fan Motor Housing is removed.

23 Preparing Fan Blade for Installation

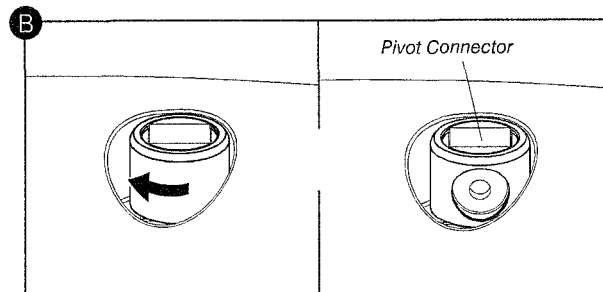
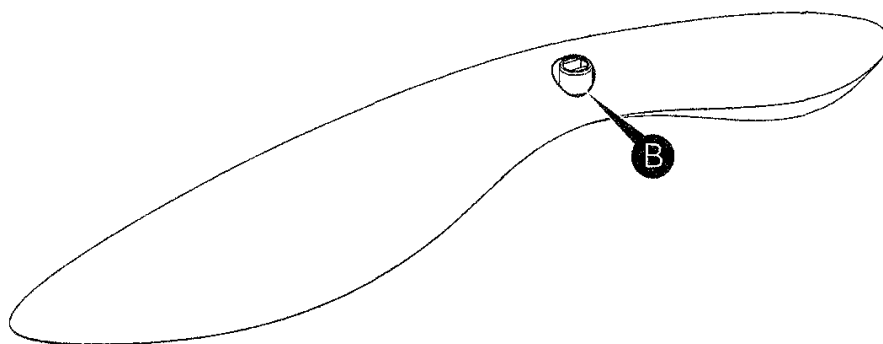

Rotate Fan Blade Screw Cover to expose fixing hole in Pivot Connector as shown,

BLADE

24 Attaching Fan Blade to Fan Motor Assembly

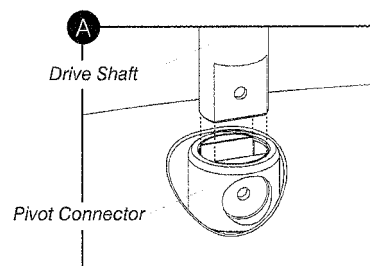
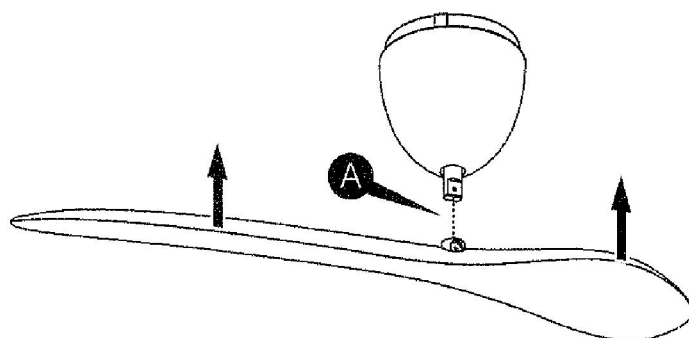

Align flats on Pivot Connector with flats on Drive Shaft and install Fan Blade by sliding Pivot Connector onto Drive Shaft,

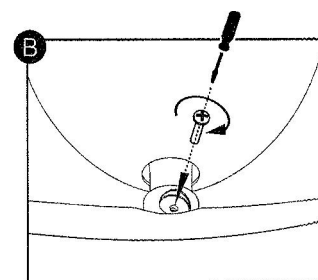
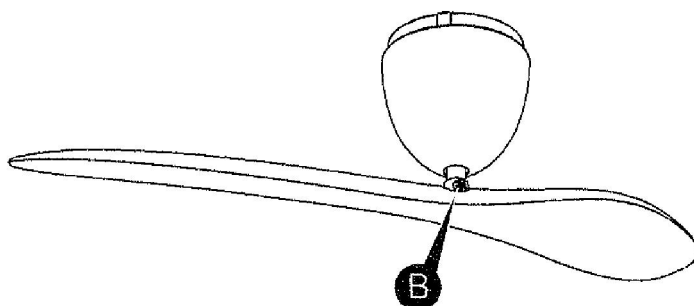

Hold Fan Blade in position, insert blade fixing screw and tighten securely,



Take care not to lift Drive Shaft when installing Fan Blade, as this may disengage Suspension Ball from lug on Hanger Bracket (see section 10)

BLADE

25 Closing Screw Cover on Pivot Connector

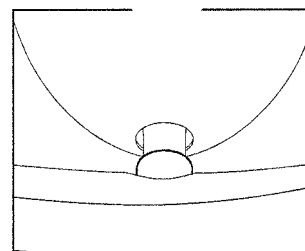
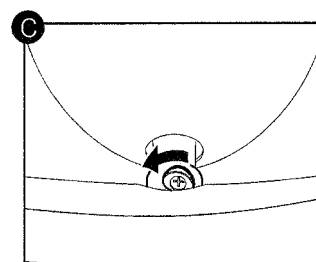
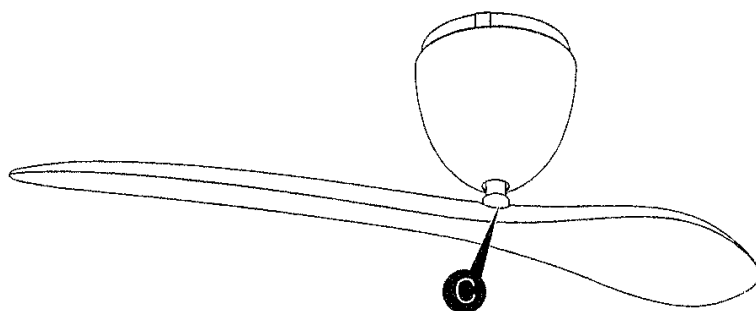

Rotate Screw Cover to hide screw head. (Note: Rotating the Screw Cover will prevent blade fixing screw from falling out should it become loose.)

26 Installation Check

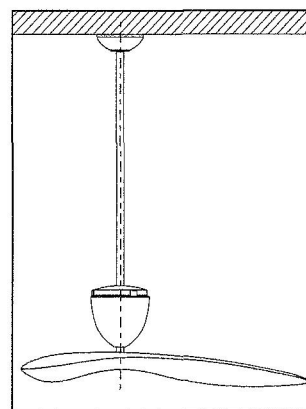
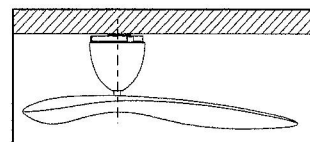
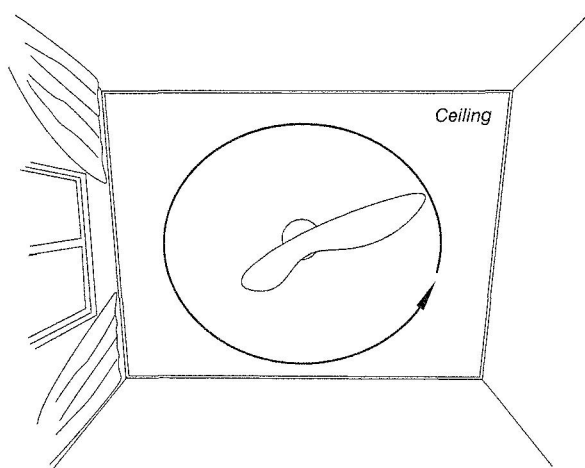

Rotate Fan Blade by hand to ensure it does not hit anything.



Make sure that the Drive Shaft is vertical, and that the gap between the Fan Motor Housing and ceiling is even. If the Drive Shaft is not vertical, the fan may wobble.

Once the installation is completed and has been checked, the electricity supply can be turned on at the main power box.

BLADE

27 Operating your Blade Fan - Remote Control



To operate your fan using a Remote Control Handset, press the HI, MED or LO button to select the desired speed.

To turn the fan off, press the STOP button.

To change between speeds, press the button for the new speed. There is no need to stop the fan when changing speed.

The LIGHT button has no function on the Blade fan.

Note:

Remote Control Transmitter may vary from one shown.

BLADE

28 Care and Cleaning

Regular cleaning of your Sycamore Ceiling Fan Blade and Fan Motor Housing is the only maintenance that is needed. Due to the balanced single blade design, a large build up of dust on the blade may eventually create an imbalance, causing the blade to wobble during use. This is likely to be more apparent on fans with a suspended installation. Regular cleaning of the blade is recommended to prevent dust from building up.

1. When cleaning your fan, only use a soft brush or lint free cloth to avoid scratching the finish. DO NOT use water when cleaning your ceiling fan. It could damage the motor or the blade and/or create the possibility of electric shock,
2. When dusting the Fan Blade, you must support the blade to prevent bending - no pressure should be applied to the blade pivot. After cleaning the Fan Blade, check to ensure that the Drive Shaft is vertical, otherwise the fan may wobble.
- 3, Occasionally, it may be necessary to re-tighten the Fan Blade and Fan Motor Housing fixing screws to prevent any clicking or humming sounds during operation. This is especially true in climates with broad temperature and humidity ranges, and for fans with high gloss painted blades or motor housings.
- 4, If you experience any flaws in the operation of your fan, please check the points in the Trouble Shooting section (see section29)

29 Troubleshooting

WARNING: Except for items 1 and 2 below, the following require access to areas of the fan which carry lethal voltage. There are no other checks which can be carried out by the user.

Apart from items 1 and 2, the following must be carried out by properly qualified person.

If the fan does not operate properly, or turns on or off at random.

1. If applicable, change the battery in the Remote Control Transmitter (Handset)
2. Check to ensure the Remote Control Code switches on the Remote Control Receiver and Transmitter (Handset) are set to same positions. Sometimes the Handset Code switches may be bumped when the battery is changed (see section 12)
3. Check the main and branch circuit breakers and/or fuses.
4. Check the wire connections to the fan.

If the fan is noisy.

1. Check to make sure that the screws securing the Suspension Ball, Fan Motor Housing and Fan Blade are tightened securely but are not over tight (see sections 9,21 & 24).
2. Check that all the screws in the Hanging Bracket are tight.

If the fan rotates but does not create much airflow.

1. The room may contain items which obstruct the air flow.
2. The fan may be too small for the size of the room.

30 General information on Ceiling Fans

General Information

1. All electrical motors, including fan motors make some noise, and may feel hot to the touch. This is NOT a fault.
2. Ceiling fans tend to move during operation due to the fact that they are not rigidly mounted. (Rigid mountings can generate excessive vibration and stress on the mountings). Movement of a couple of centimetres is quite OK and does not suggest that the fan will fall down. The Blade fan is mounted securely on a metal Hanger Bracket with rubber cushioning and a ball joint to allow free movement. Please note that due to manufacturing variations not all Blade ceiling fans are exactly the same - some may move more than others. Note: Excessive wobble can be caused by the Drive Shaft not being positioned vertically. This can be easily rectified by adjusting the position of the Fan Motor Assembly in the Hanger Bracket (see section 10).
3. Ceiling fans are an environmentally smart choice to help cool you in your home. They work by creating air flow which causes a cooling sensation on the skin. The faster the speed of the air flow, the greater the cooling sensation. Ceiling fans do not work by cooling the room, so they should be switched off when there is no one in the room, to save energy. The effectiveness of ceiling fans is also dependent on the humidity in the air - they are more effective in humid environments, and less so in dry ones.
4. During winter, a slowly turning fan may help to reduce heating costs. Warm air rises to the ceiling, where it cannot be felt by the occupants of a room, especially in areas with high ceilings. The fan helps to keep warm air away from the ceiling, and mixes it with the air below. Keep the fan speed low, so that the effects of evaporative cooling are minimized.

Normal Wear and Tear

1. Threaded components working slightly loose or parts even slightly damaged or bent during vigorous cleaning or bumping can cause extra wobble and noise. This is not covered under warranty, but care during maintenance and cleaning should prevent this from occurring.

BLADE

31 Technical Specifications

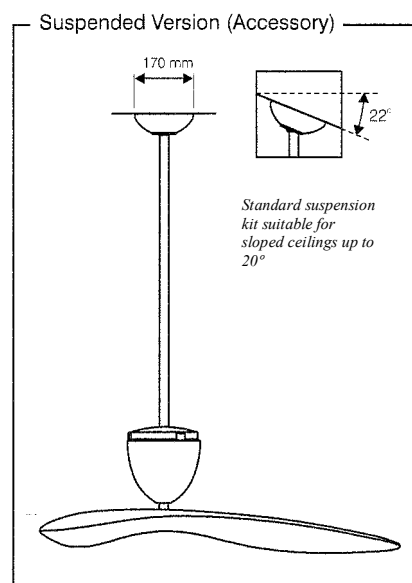
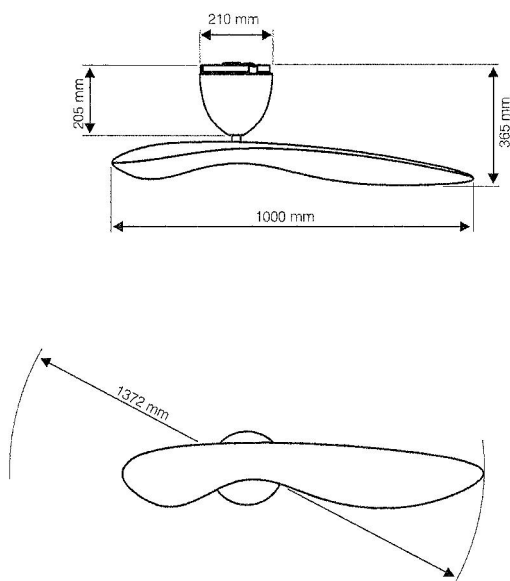

Colour

Motor Housing: White / Brushed Aluminium
Blade: White / Brushed Silver

Operating Speeds (Approximate figures at 230-240v AC)

Low: 80 rpm
Medium: 120 rpm
High: 160 rpm

Remote Control (Accessory)

Hand Held, RF

Rated Power Consumption

35W

32 Warranty

Ceiling Fan Warranty.

You must have the original purchase receipt or bill of sale to make a warranty claim. No claim will be accepted unless proof of date of purchase is available at the time of making the warranty claim.

Ceiling Fan Warranty Period.

The ceiling fan itself, excluding accessories such as the Remote Control Transmitter and Receiver, is covered by a 1 year in-home warranty. During this period, Fantasia Distribution Ltd will, at its discretion, repair or replace defective product. Labour and product delivery costs are **borne** by Fantasia Distribution Ltd during this 1 year period. **Fantasia Distribution Ltd must authorize repairs and the costs associated. No costs will be refunded unless Fantasia Distribution Ltd have agreed to them in advance of any work taking place.** The cost of obtaining or using special access equipment (scissor lifts, scaffolding etc.) is specifically excluded, and it is the responsibility of the owner to provide such equipment and have it safely installed and operated.

Following the 1 year in-home warranty period, Fantasia Distribution Ltd, offers a repair or replacement warranty on the motor assembly only, for an additional 14 years. During this 14 years, the owner is responsible for labour costs incurred in removing and re-installing the fan, and for transport costs to Fantasia Distribution Ltd's repair centre. Return freight will be paid by Fantasia Distribution Ltd.

Remote Control Warranty Period.

Fantasia Distribution Ltd's Remote Control Receivers and Transmitters (Handsets) are covered by a 1 year in-home warranty under the same conditions as described above for fans, The additional 1 year repair or replacement warranty option is offered for Remote Control Transmitters or Receivers.

Balance of Warranty on Repaired or Replaced Products.

Any replaced or repaired product is covered only by the balance of the warranty remaining on the original article.

Transfer of Warranty.

If the dwelling where the fan or remote control is installed changes hands, the balance of the warranty passes to the new owner, providing the original bill of sale for the product is retained by the new owner.

Warranty for the fan does not cover damage to the fan if it is moved from one dwelling to another during the warranty period. The warranty is voided in total if the product is sold as second hand goods.

33 Warranty

The following is NOT covered by warranty.

1. Any damage incurred after delivery to the owner that is not caused by a fault in the products materials or workmanship; damage from lightning or power surges; incorrect installation; damage due to incorrect installation; water damage of any kind; installation or use outdoors; damage arising from connection to or use with alternative power systems (e.g. inverters, solar, etc.).
2. Ceiling fans not installed by a licensed electrician.
3. Repair of a ceiling fan used incorrectly, accidentally damaged, modified in any way or not serviced in accordance with the maintenance instructions.
4. Travelling costs incurred by Fantasia Distribution Ltd's personnel or service agents over 25km from a Fantasia Distribution Ltd authorised service depot. and/or the cost of transporting and insuring the ceiling fan between the nearest Fantasia Distribution Ltd agents' service depot and its normal location.
These costs must be met by the purchaser
5. Subject to any statutory provisions to the contrary, claims for damage to furniture, carpet, walls, ceilings, foundations or any other consequential loss either directly or indirectly resulting from a faulty ceiling fan.
6. Blade Ceiling Fans not purchased and installed in Mainland UK.
7. A service call fee will be charged where; there is nothing wrong with the ceiling fan or; the defective operation of the ceiling fan is due to failure of electricity or; the installation is not in accordance with Fantasia Distribution Ltd instructions and/or applicable local regulations or; the defects have been caused by incorrect application or abuse of the ceiling fan or; the damage has been caused by unauthorised persons attempting to repair the fan.

BLADE



BLADE

34 Unpacking your Blade Fan Suspension Kit

Unpack your Suspension Kit and check the contents. You should have the following items. Do not discard the carton. If warranty replacement or repair is ever necessary, the fan should be returned in the original packaging

Examine all parts. You should have the following:



Canopy
x 1 unit



Canopy Screw Cover x
1 unit

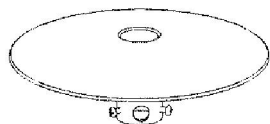

Suspension Cover
x 1 unit

Suspension Hardware

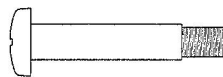

Screw (Shoulder type) x
2 units

**Packaged
separately**



**Suspension
Rod** x 1 unit

35 Preparing Fan Motor Assembly for Suspended Installation

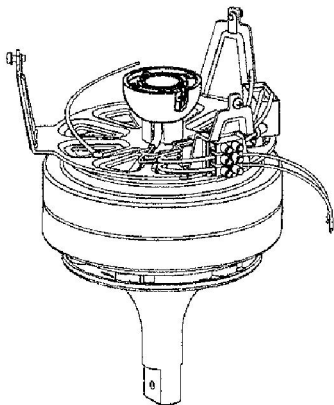

Remove Suspension Ball from Fan Motor Assembly.

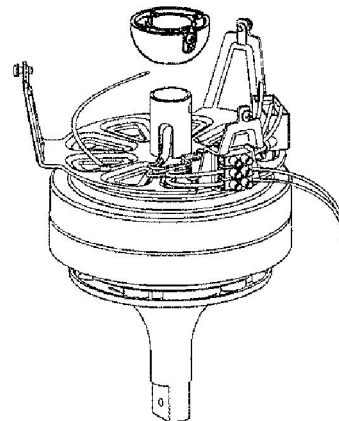

Put Suspension Pin and Suspension Ball aside for later use.

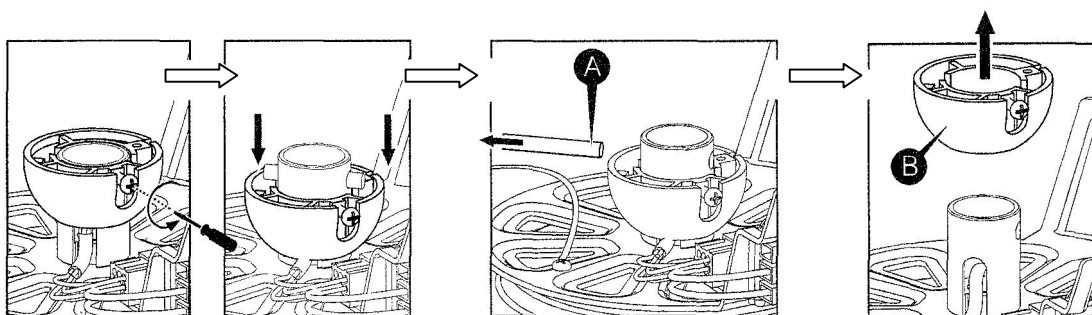

Loosen Suspension Ball security screw, slide Suspension Ball down shaft and remove Suspension Pin. Remove Suspension Ball from shaft.

36 Preparing Fan Motor Assembly

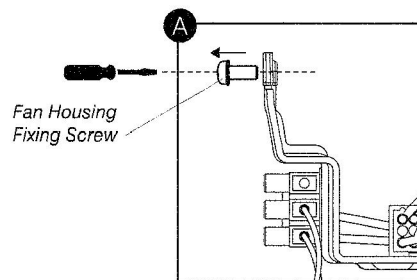
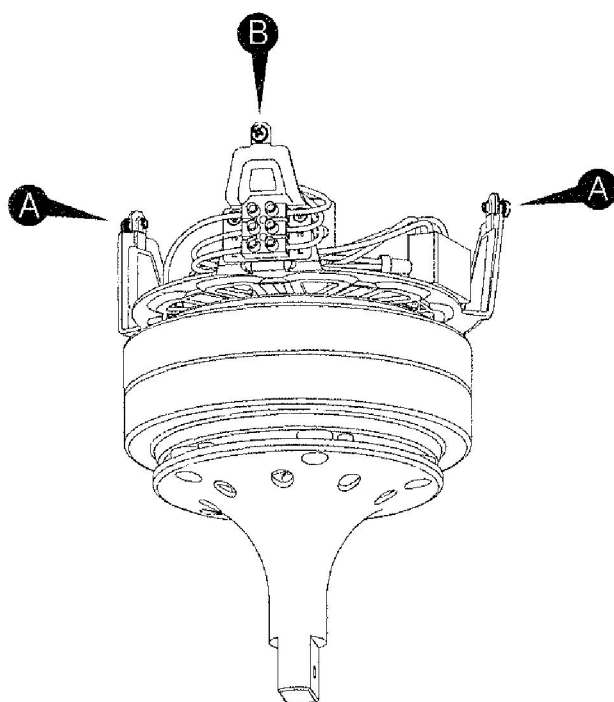

Remove one Fan Motor Housing fixing screw, and put it aside for re-assembly during Fan Motor Housing installation.

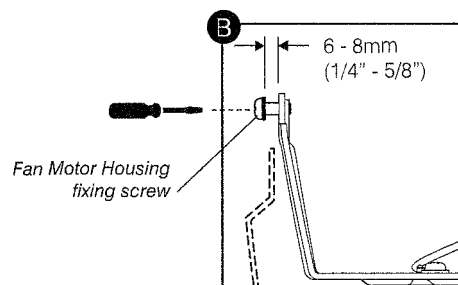

Adjust remaining two Fan Motor Housing fixing screws to provide clearance for installing Fan Motor Housing.

37 Preparing Suspension Rod

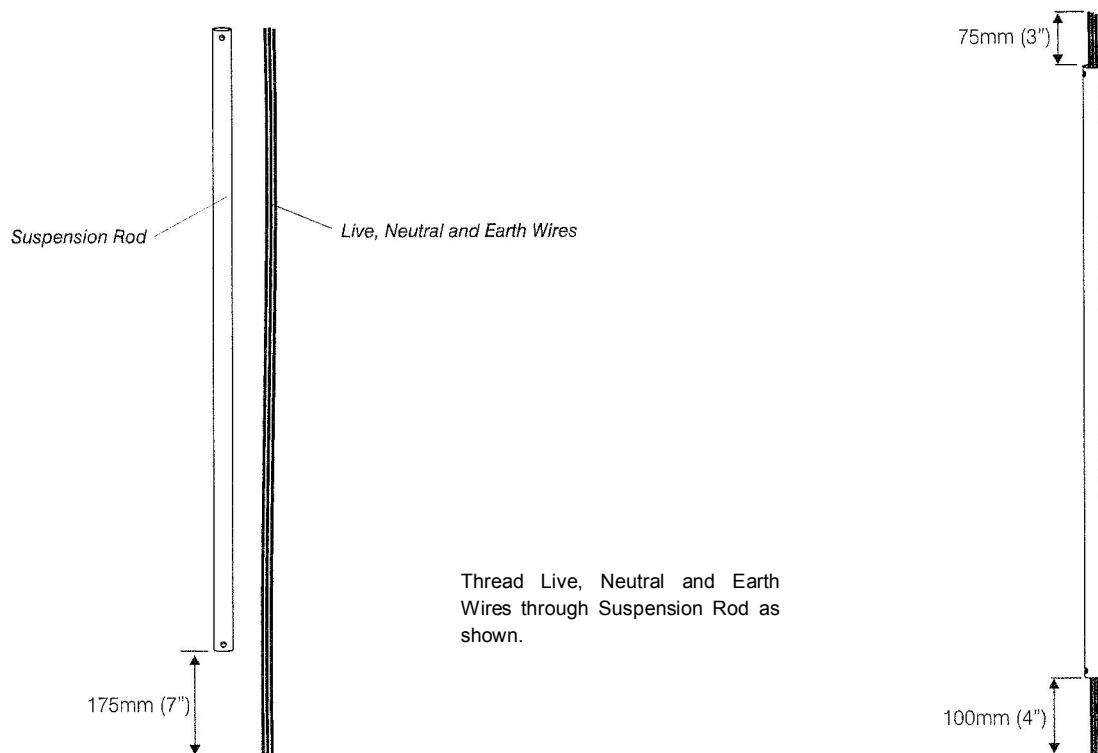

38 Attaching Suspension Rod to Suspension Cover

Ensure two upper security screws do not protrude into bore of Suspension Cover.

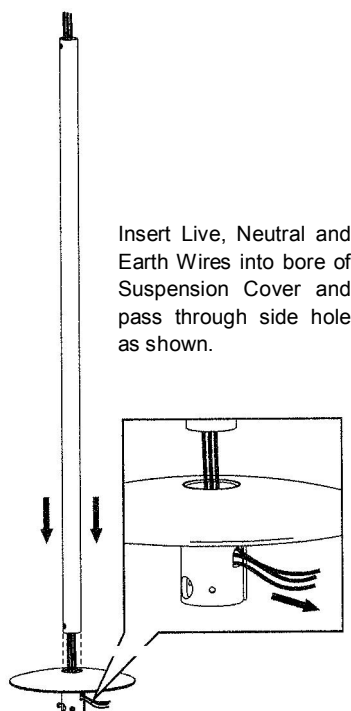
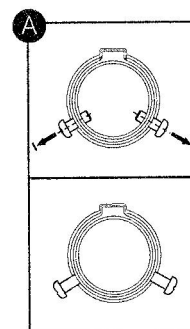
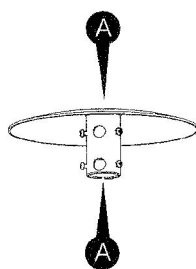

Insert Live, Neutral and Earth Wires into bore of Suspension Cover and pass through side hole as shown.

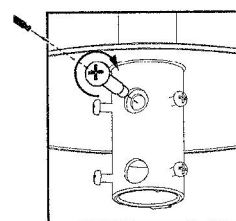

Insert Suspension Rod into Suspension Cover, align holes in Suspension Rod and Suspension Cover, insert upper shoulder screw and tighten.

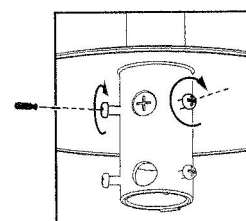

Tighten two upper security screws.

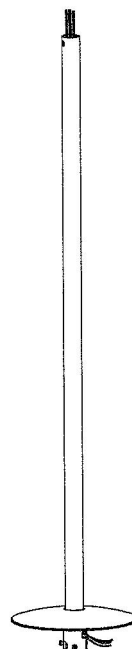

39 Attaching Suspension Cover to Fan Motor Assembly

Note: Suspension Rod should be attached

Ensure two lower security screws do not protrude into bore of suspension cover.

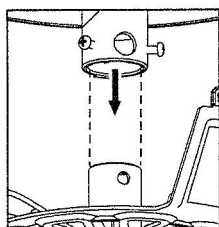

Insert Fan Motor Assembly shaft into Suspension Cover bore and align holes in Suspension Cover and Fan Motor Assembly shaft.

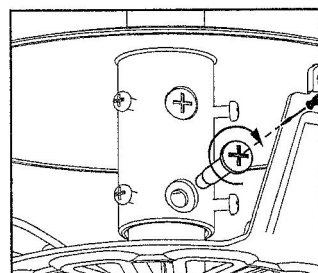
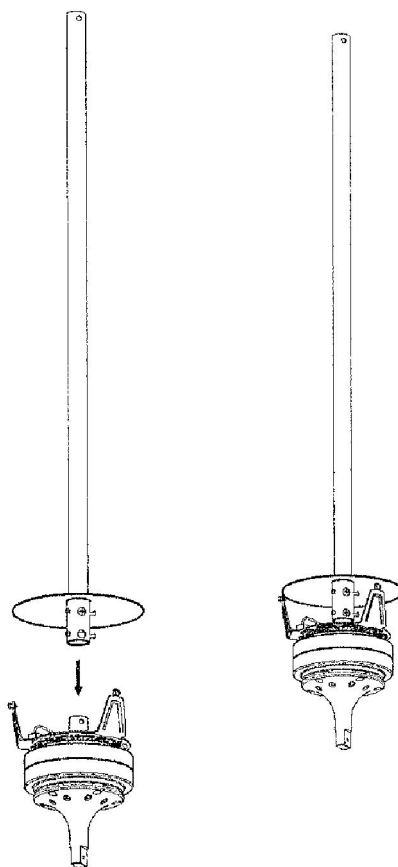

Insert and tighten lower shoulder screw.

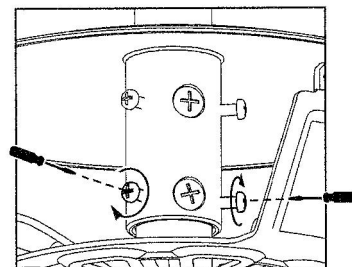

Tighten two lower security screws.

40 Removing pre-installed Live and Neutral Wires from Fan Motor Assembly

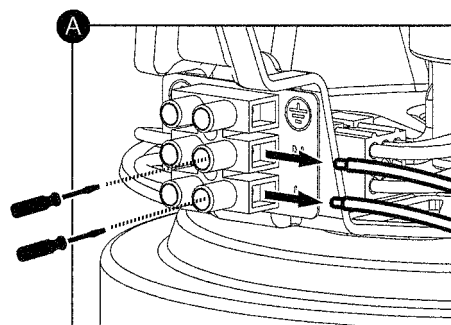
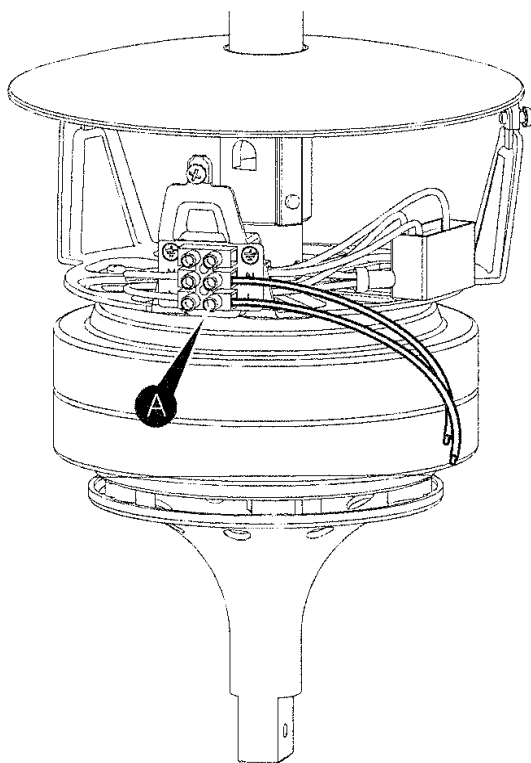

Remove pre-installed LIVE (Brown) and NEUTRAL (Blue) wires from right side of terminal block on Fan Motor Assembly.

41 Connecting Live, Neutral and Earth Wires to Terminal Block on Fan Motor Assembly

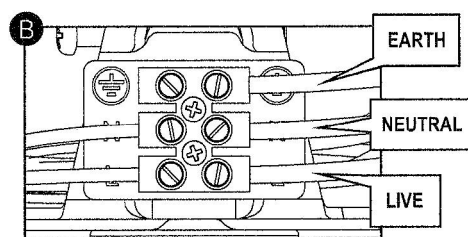
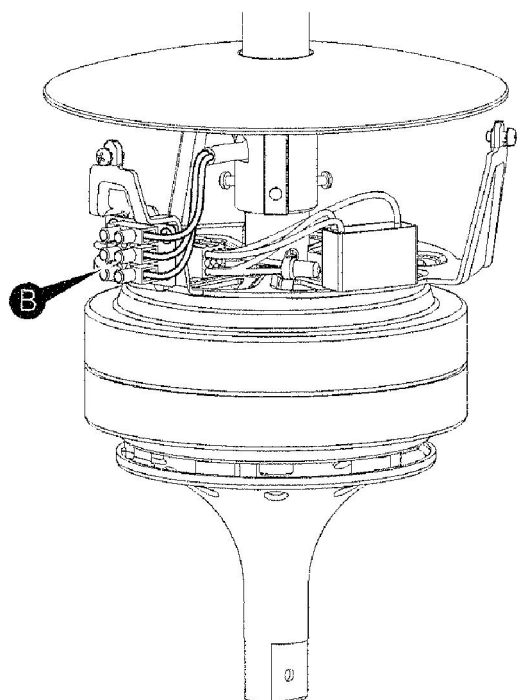

Make LIVE, NEUTRAL and EARTH connections from Suspension Rod Wires to appropriate terminals on Fan Motor Assembly terminal block as shown.

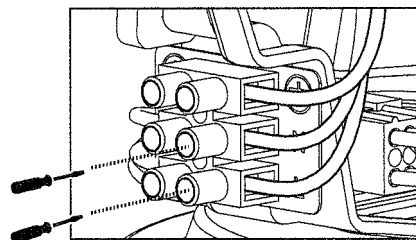

Ensure that electrical connections are good, and terminal block screws are secure.

42 Connecting Earth Wire to Terminal Block on Fan Motor Assembly

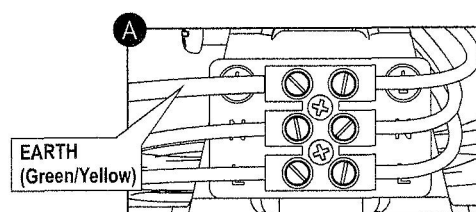
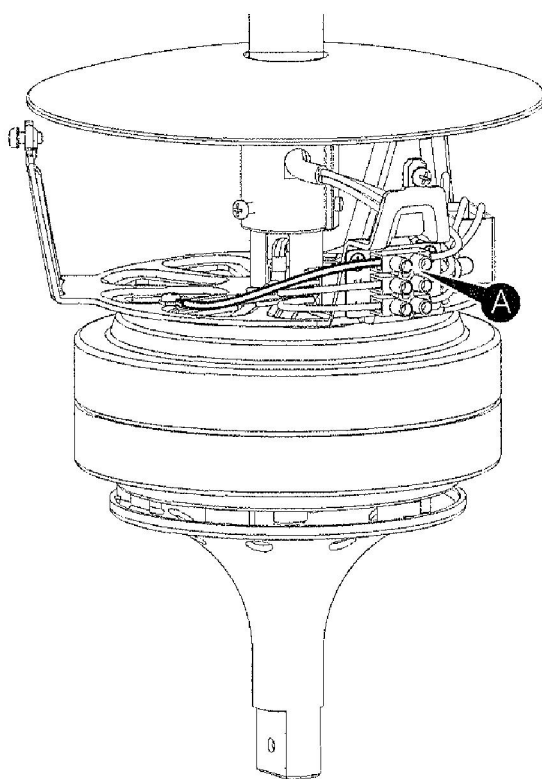

Make EARTH (Green/Yellow) connection from Chassis to appropriate terminal on Fan Motor Assembly terminal block as shown.

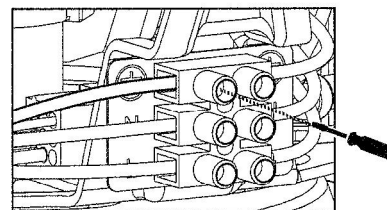

Ensure that electrical connections are good, and terminal block screws are secure.

43 Assembling Canopy Screw Cover and Canopy to Suspension Rod

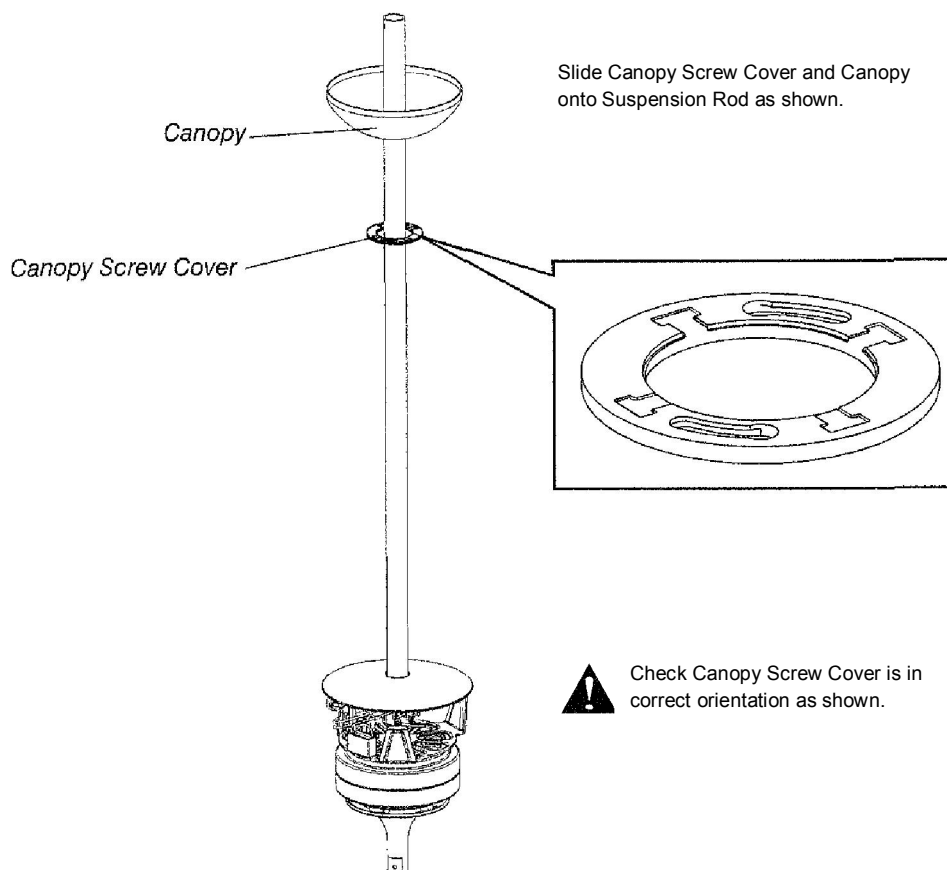

44 Attaching Suspension Ball to Suspension Rod

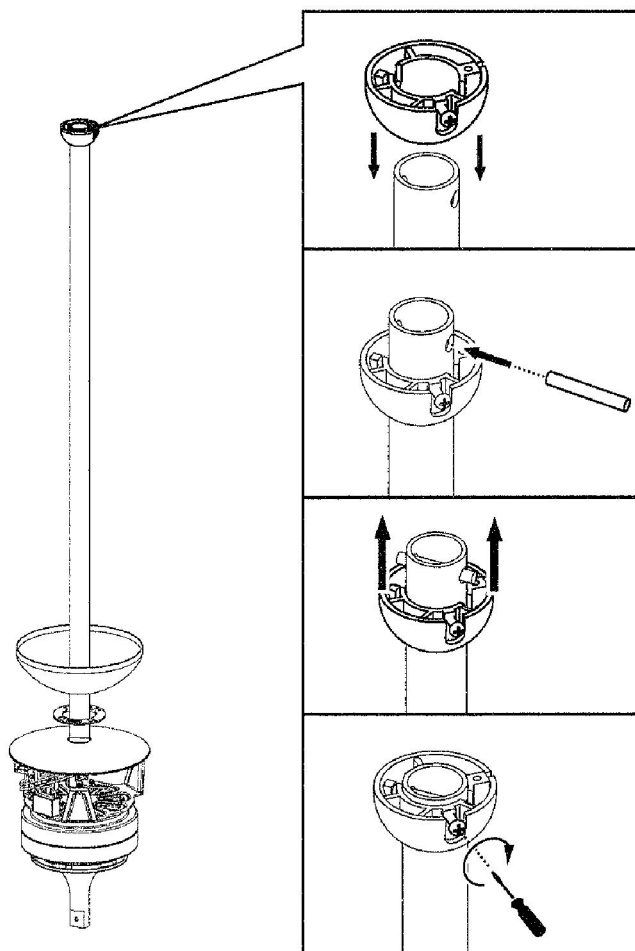

Locate Suspension Ball and Suspension Pin removed from Fan Motor Assembly on page 5.

Slide Suspension Ball onto Suspension Rod, insert Suspension Pin, locate Suspension Ball onto Suspension Pin and tighten security screw securely.

45 Installing Fan Motor/Suspension Rod Assembly into Hanger Bracket

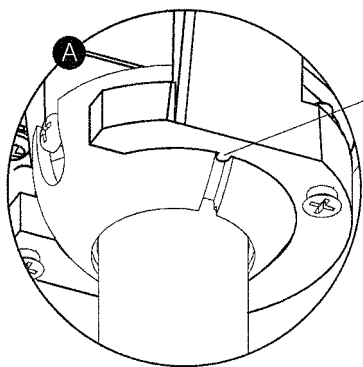
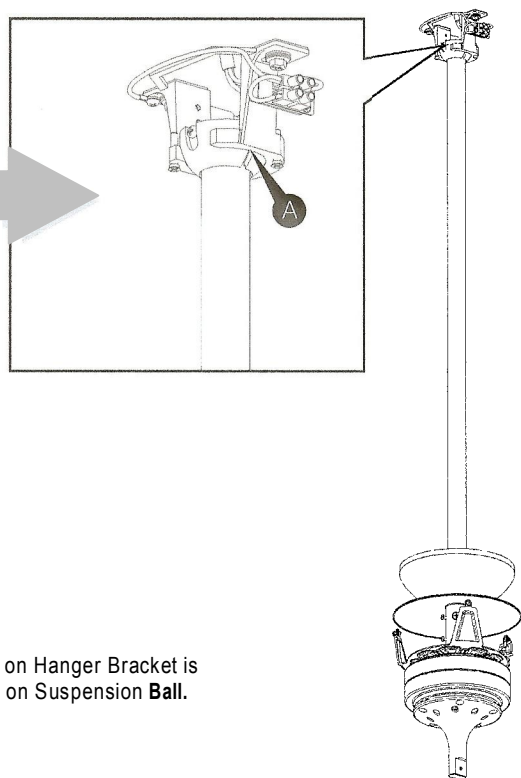
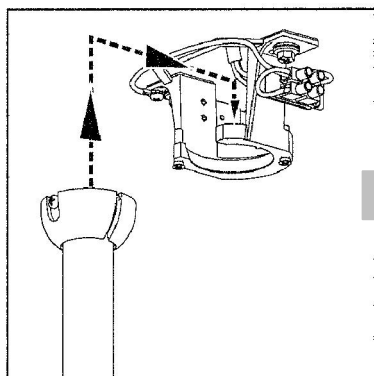

Ensure that lug on Hanger Bracket is engaged in slot on Suspension **B**all.

46 Installing Remote Control Receiver

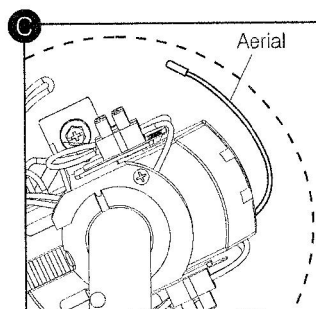
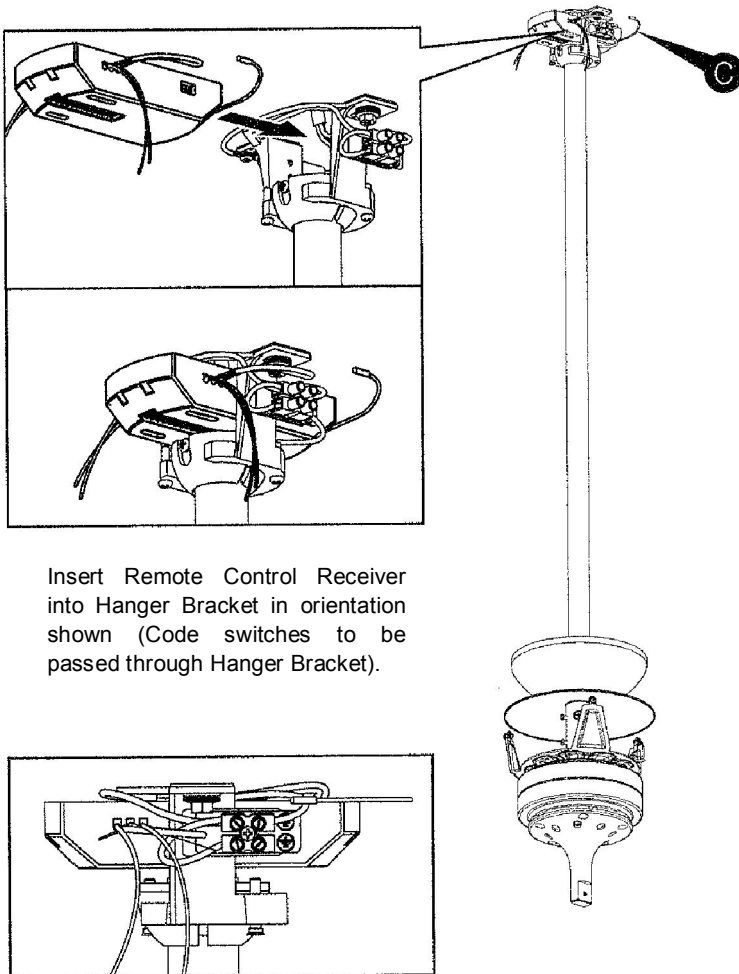

Fix Remote Control Receiver aerial to ceiling, within circle of canopy.

47 Connecting Live and Neutral Wires from Receiver to Suspension Rod Wires

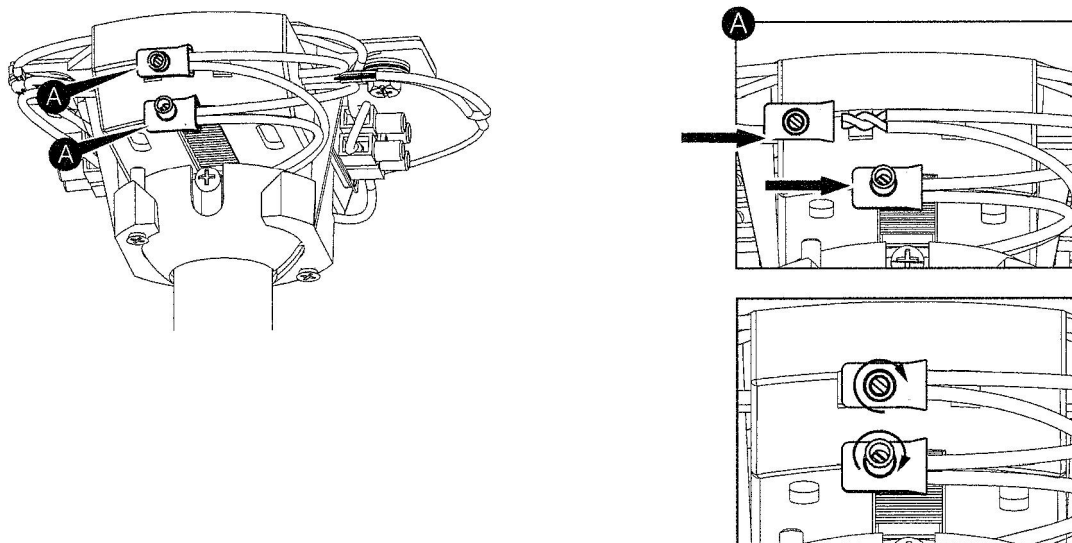

Make LIVE and NEUTRAL connections from Wires passing through Suspension Rod to Remote Control Receiver wires marked L (Brown) and N (Blue) respectively, using suitable insulated connectors (not supplied).

Ensure that electrical connections are good, and connector screws are secure.

48 Connecting Earth Wire to Terminal Block on Hanger Bracket - Remote Control

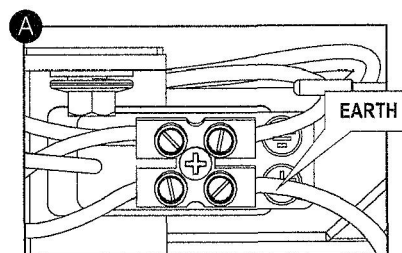
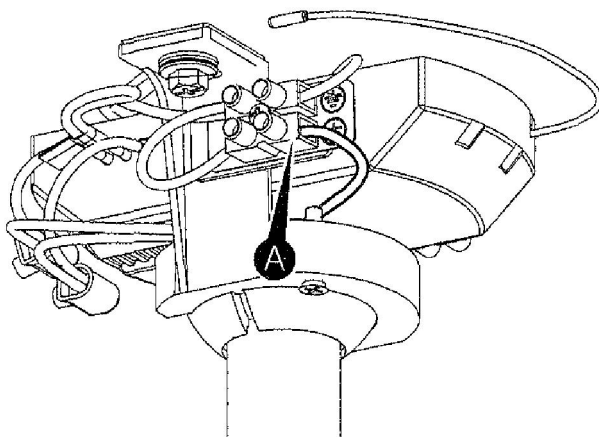

Make EARTH connection from wire passing through Suspension Rod to appropriate terminal on Hanger Bracket as shown.

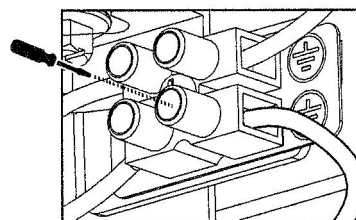

Ensure that electrical connections are good, and terminal block screws are secure.

49 Connecting Live and Neutral Wires to Terminal Block on Hanger Bracket - Remote Control

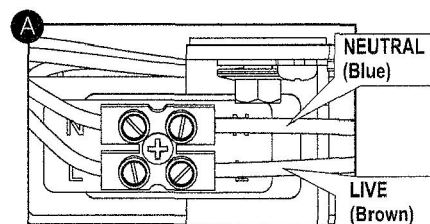
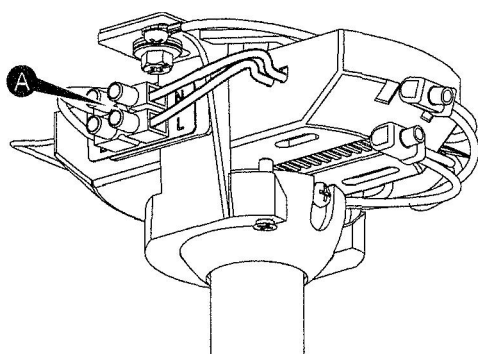

Make LIVE (Brown) and NEUTRAL (Blue) connections from Remote Control Receiver to Hanger Bracket terminals using wires marked LIVE IN (Brown) and NEUTRAL IN (Blue).

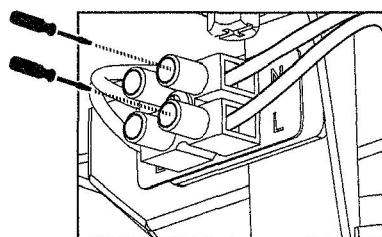

Ensure that electrical connections are good, and terminal block screws are secure.

50 Attaching Canopy to Hanger Bracket

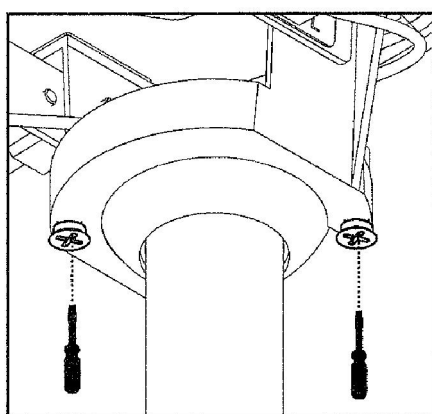

Adjust Canopy fixing screws on Hanger Bracket as shown

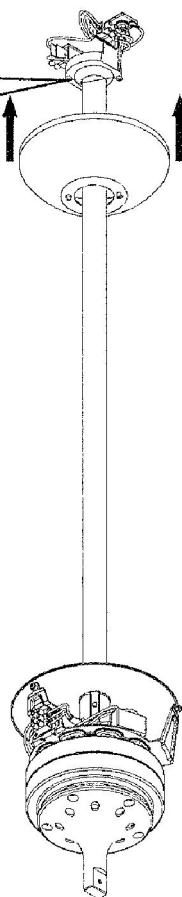

Slide Canopy up Suspension Rod, fit to Hanger Bracket using clockwise bayonet action and tighten fixing screws securely.

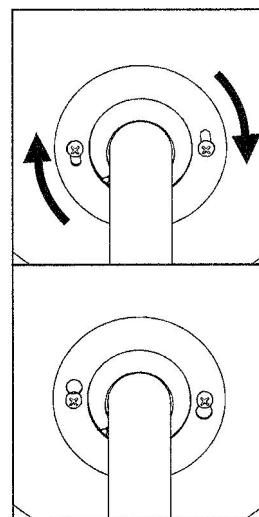

Remove protective rubber gasket.

51 Attaching Canopy Screw Cover to Canopy

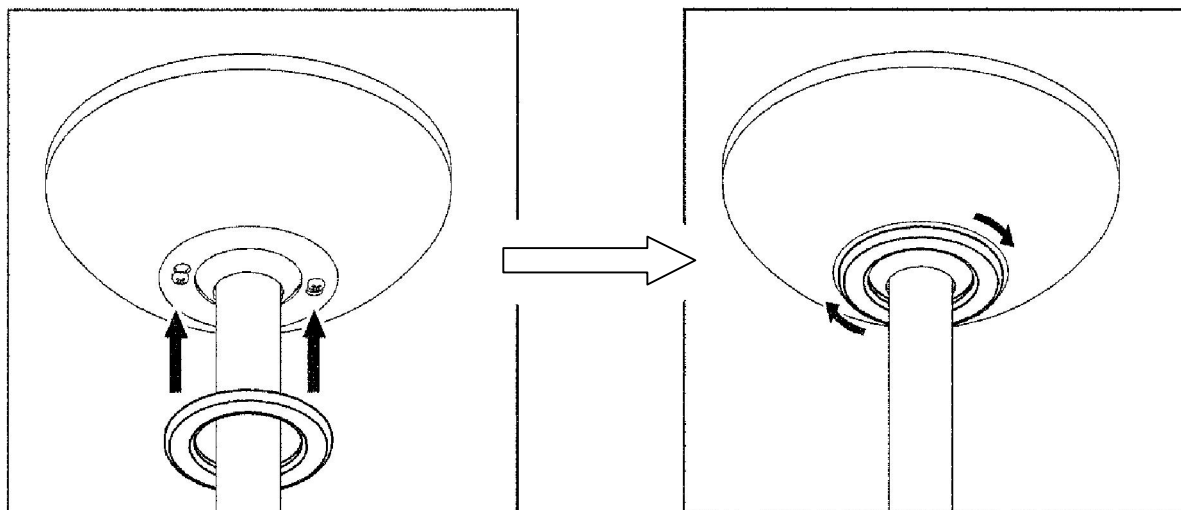

Fit Canopy Screw Cover to Canopy using a bayonet action as shown.

52 Preparing Fan Motor Housing

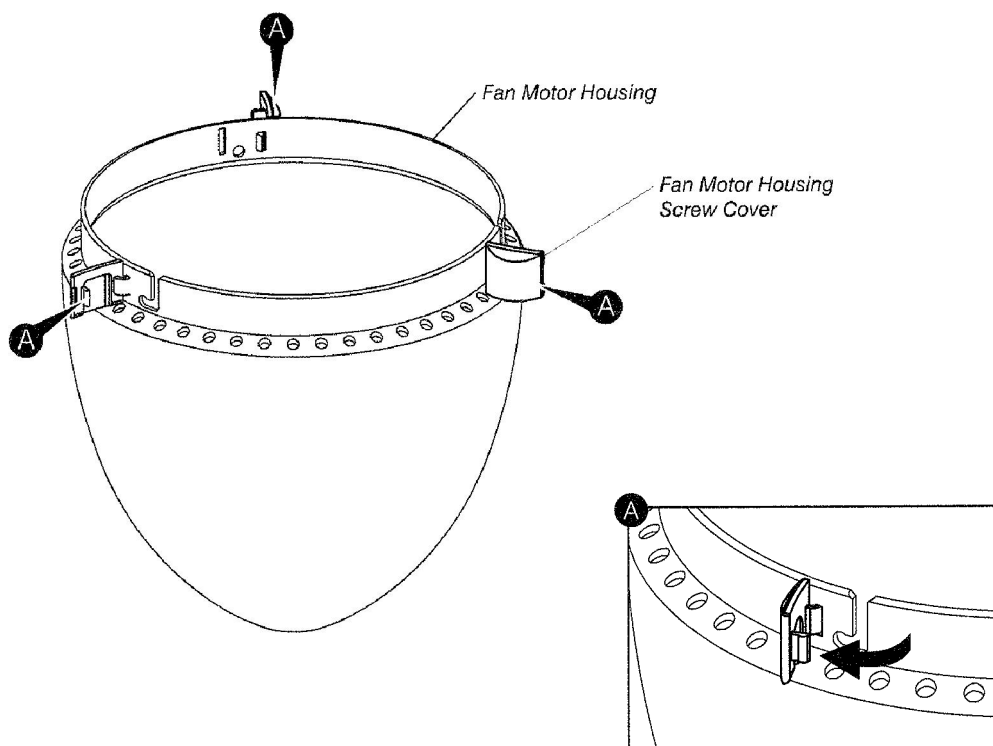

Ensure Fan Motor Housing Screw Covers are in fully open position.

53 Attaching Motor Housing to Fan Motor Assembly

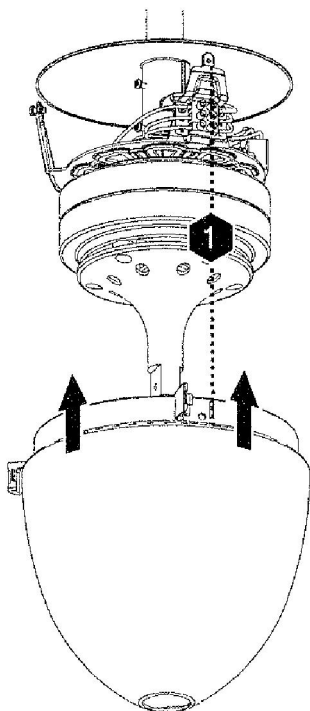

Ensure that Fan Motor Housing fixing point with hole (not bayonet slot) is aligned with Chassis arm from which fixing screw was removed (see page 6).

Install Fan Motor Housing using a clockwise bayonet action.

Line up fixing hole in Fan Motor Housing with screw hole in Chassis arm and install fixing screw removed on page 6.

Secure Fan Motor Housing, ensuring all three screws are tight but not over tight.

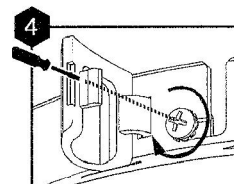
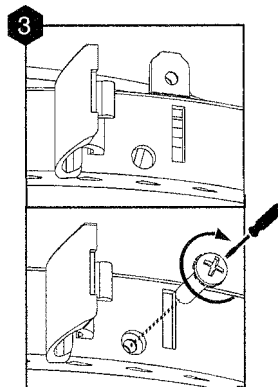
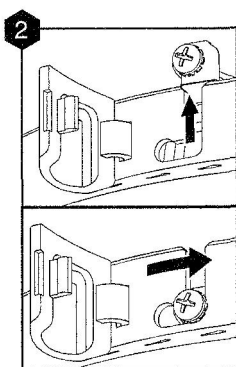

54 Closing Screw Covers

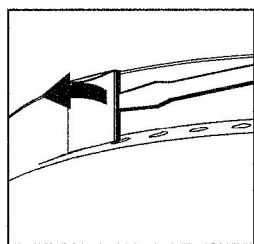
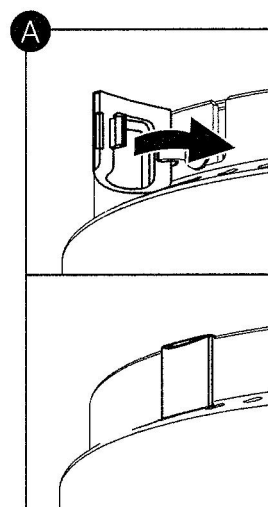
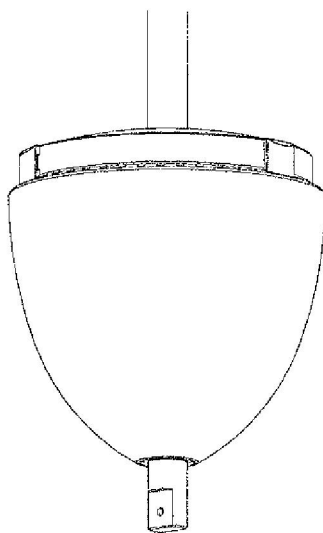
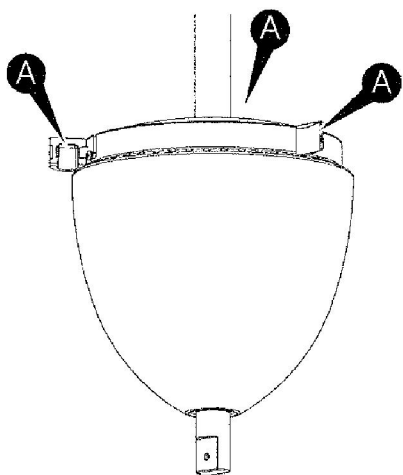

Note: To remove Fan Motor Housing open Screw Covers using a flat bladed screw driver as shown. Remove fixing screw from hole, loosen two bayonet slot screws and remove Fan Motor Housing by rotating anticlockwise and lowering.



Fan Blade must be removed before Fan Motor Housing is removed.

55 Product Disposal Instructions



This product has been classed as Electrical or Electronic Equipment and should not be disposed of with other household or commercial waste at the end of it's working life.

The Waste of Electrical and Electronic Equipment (WEEE) Directive (2002/96/EC) has been put in place to recycle products using best available practise and minimise the impact upon the environment.